

Contract of sale of land

The vendor agrees to sell and the purchaser agrees to buy the property, being the land and the goods, for the price and on the terms set out in this contract.

The terms of this contract are contained in the -

- particulars of sale; and
- special conditions, if any; and
- general conditions (which are in standard form: see general condition 6.1)

in that order of priority.

SIGNING OF THIS CONTRACT

WARNING: THIS IS A LEGALLY BINDING AGREEMENT. YOU SHOULD READ THIS CONTRACT BEFORE SIGNING IT.

Purchasers should ensure that they have received a section 32 statement from the vendor before signing this contract. In this contract, "section 32 statement" means the statement required to be given by a vendor under section 32 of the *Sale of Land Act 1962*.

The authority of a person signing -

- under power of attorney; or
- as director of a corporation; or
- as agent authorised in writing by one of the parties - must be noted beneath the signature.

Any person whose signature is secured by an estate agent acknowledges being given by the agent at the time of signing a copy of the terms of this contract.

SIGNED BY THE PURCHASER:

..... on/...../2025

Print name(s) of person(s) signing:

.....

State nature of authority, if applicable:

This offer will lapse unless accepted within [] clear business days (3 clear business days if none specified)
In this contract, "business day" has the same meaning as in section 30 of the *Sale of Land Act 1962*

SIGNED BY THE VENDOR:

..... on/...../2025

Print name(s) of person(s) signing: **BRADLEY RUPERT BIBBY**

State nature of authority, if applicable:

The **DAY OF SALE** is the date by which both parties have signed this contract.

IMPORTANT NOTICE TO PURCHASERS – COOLING-OFF

Cooling-off period (Section 31 of the *Sale of Land Act 1962*)

You may end this contract within 3 clear business days of the day that you sign the contract if none of the exceptions listed below applies to you.

You must either give the vendor or the vendor's agent **written** notice that you are ending the contract or leave the notice at the address of the vendor or the vendor's agent to end this contract within this time in accordance with this cooling-off provision.

You are entitled to a refund of all the money you paid EXCEPT for \$100 or 0.2% of the purchase price (whichever is more) if you end the contract in this way.

EXCEPTIONS: The 3-day cooling-off period does not apply if:

- you bought the property at a publicly advertised auction or on the day on which the auction was held; or
- you bought the land within 3 clear business days before a publicly advertised auction was to be held; or
- you bought the land within 3 clear business days after a publicly advertised auction was held; or
- the property is used primarily for industrial or commercial purposes; or
- the property is more than 20 hectares in size and is used primarily for farming; or
- you and the vendor have previously signed a contract for the sale of the same land in substantially the same terms; or
- you are an estate agent or a corporate body.

*This contract is approved as a standard form of contract under section 53A of the *Estate Agents Act 1980* by the Law Institute of Victoria Limited. The Law Institute of Victoria Limited is authorised to approve this form under the *Legal Profession Uniform Law Application Act 2014*.

Table of contents

Particulars of Sale

Special Conditions

General Conditions

1.	ELECTRONIC SIGNATURE	6
2.	LIABILITY OF SIGNATORY	6
3.	GUARANTEE	6
4.	NOMINEE	6
5.	ENCUMBRANCES	6
6.	VENDOR WARRANTIES	6
7.	IDENTITY OF THE LAND.....	7
8.	SERVICES.....	7
9.	CONSENTS.....	7
10.	TRANSFER & DUTY	7
11.	RELEASE OF SECURITY INTEREST	7
12.	BUILDING WARRANTY INSURANCE.....	8
13.	GENERAL LAW LAND	8
14.	DEPOSIT	9
15.	DEPOSIT BOND.....	10
16.	BANK GUARANTEE.....	10
17.	SETTLEMENT	11
18.	ELECTRONIC SETTLEMENT	11
19.	GST.....	12
20.	LOAN	12
21.	BUILDING REPORT	12
22.	PEST REPORT	13
23.	ADJUSTMENTS	13
24.	FOREIGN RESIDENT CAPITAL GAINS WITHHOLDING	13
25.	GST WITHHOLDING.....	14
26.	TIME & CO OPERATION	15
27.	SERVICE	15
28.	NOTICES.....	16
29.	INSPECTION.....	16
30.	TERMS CONTRACT	16
31.	LOSS OR DAMAGE BEFORE SETTLEMENT	16
32.	BREACH.....	16
33.	INTEREST	17
34.	DEFAULT NOTICE.....	17
35.	DEFAULT NOT REMEDIED.....	17

NOTICE TO PURCHASERS OF PROPERTY OFF-THE-PLAN

Off-the-plan sales (Section 9AA(1A) of the *Sale of Land Act 1962*)

You may negotiate with the vendor about the amount of the deposit moneys payable under the contract of sale, up to 10 per cent of the purchase price.

A substantial period of time may elapse between the day on which you sign the contract of sale and the day on which you become the registered proprietor of the lot.

The value of the lot may change between the day on which you sign the contract of sale of that lot and the day on which you become the registered proprietor.

PARTICULARS OF SALE

VENDOR'S ESTATE AGENT

HF Richardson Livestock & Property Pty Ltd
5 Retreat Road, Newtown, VIC 3220
Email: admin@hfrichardson.com.au
Tel: (03) 5229 8017

VENDOR

BRADLEY RUPERT BIBBY

1006 Barkly Road, Navarre, VIC 3384

VENDOR'S LEGAL PRACTITIONER OR CONVEYANCER

MCL Legal

78 Napier Street, St Arnaud VIC 3478
PO Box 6, St Arnaud Vic 3478
Email: property@mclegal.com.au
Tel: 03 5495 1033 Ref: ML:JM:250228

PURCHASER

Name:

Address:

ABN/ACN:

Email:

PURCHASER'S LEGAL PRACTITIONER OR CONVEYANCER

Name:

Address:

Email:

Tel: Mob: Fax: Ref:

LAND (general conditions 7 and 13)

The land is described in the table below –

Certificate of Title reference				being lot	on plan
Volume	2869	Folio	737	CA 46 Sec D	Parish Barkly
Volume	3048	Folio	465	CA 45 Sec D	Parish Barkly
Volume	11611	Folio	969	CA 5 Sec D	Parish Barkly

If no title or plan references in the table, the land is as described in the section 32 statement or the register search statement and the document referred to as the diagram location in the register search statement attached to the section 32 statement

The land includes all improvements and fixtures.

PROPERTY ADDRESS

The address of the land is: **Stawell-Avoca Road, Barkly 3384**

GOODS SOLD WITH THE LAND (general condition 6.3(f)) *(list or attach schedule)*

Nil

PAYMENT

Price	\$	
Deposit	\$	by
Balance	\$	payable at settlement

DEPOSIT BOND

☐ General condition 15 applies only if the box is checked

BANK GUARANTEE

☐ General condition 16 applies only if the box is checked

GST (general condition 19)

Subject to general condition 19.2, the price includes GST (if any), unless the next box is checked

- ☐ GST (if any) must be paid in addition to the price if the box is checked
- ☒ This sale is a sale of land on which a 'farming business' is carried on which the parties consider meets the requirements of section 38-480 of the GST Act if the box is checked
- ☐ This sale is a sale of a going concern' if the box is checked
- ☐ The margin scheme will be used to calculate GST if the box is checked

SETTLEMENT (general conditions 17 & 26.2)**is due on**

unless the land is a lot on an unregistered plan of subdivision, in which case settlement is due on the later of:

- the above date; and
- the 14th day after the vendor gives notice in writing to the purchaser of registration of the plan of subdivision.

LEASE (general condition 5.1)

☐ At settlement the purchaser is entitled to vacant possession of the property unless the box is checked, in which case the property is sold subject to*:

*(*only one of the boxes below should be checked after carefully reading any applicable lease or tenancy document)*

☐ a lease for a term ending on with options to renew, each of years

OR

☐ a residential tenancy for a fixed term ending on

OR

☐ a periodic tenancy determinable by notice

TERMS CONTRACT (general condition 30)

☐ This contract is intended to be a terms contract within the meaning of the *Sale of Land Act 1962* if the box is checked. *(Reference should be made to general condition 30 and any further applicable provisions should be added as special conditions)*

LOAN (general condition 20)

☐ This contract is subject to a loan being approved and the following details apply if the box is checked:

Lender:

(or another lender chosen by the purchaser)

Loan amount: no more than

Approval date:

BUILDING REPORT

☐ General condition 21 applies only if the box is checked

PEST REPORT

☐ General condition 22 applies only if the box is checked

Special Conditions

Instructions: *It is recommended that when adding special conditions:*

- *each special condition is numbered;*
- *the parties initial each page containing special conditions;*
- *a line is drawn through any blank space remaining on the last page; and*
- *attach additional pages if there is not enough space*

Special Condition 1 Deposit (paper settlements only)

- ☐ If the deposit is:
- (a) paid by Deposit Guarantee;
 - (b) less than 10% deposit of the price; or
 - (c) not paid at all,
- despite any general condition or special condition to the contrary, the purchaser must pay the fees on up to six cheques drawn on an authorised deposit-taking institution.

Special Condition 2 Auction

- ☐ The property is offered for sale by public auction, subject to the vendor's reserve price. The rules for the conduct of the auction shall be as set out in the schedules to the Sale of Land (Public Auctions) Regulations 2014 or any rules prescribed by regulation which modify or replace those rules.

Special Condition 3 Guarantee

- ☒ If the Purchaser is a company, the Purchaser shall forthwith upon execution of this Contract procure the execution by each of its directors of the Guarantee annexed to that part of this Contract to be held by the Vendor.

Special Condition 4 Execution of Contract of Sale

- ☒ The parties agree that this Contract may be executed in accordance with the provisions of the *Electronic Transactions (Victoria) Act 2000* and in any number of counterparts and all counterparts shall be taken to constitute one instrument, with the date of this Contract being the date on which it is executed by the last party.

Special Condition 5 Amendment to General Conditions

- ☒ The parties acknowledge and agree that:
- 5.1 For the purposes of General Condition 23, the expression "periodic outgoings" does not include any amounts to which section 10G of the *Sale of Land Act 1962* applies.
 - 5.2 General Condition 28 does not apply to any amounts to which sections 10G or 10H of the *Sale of Land Act 1962* apply.

General Conditions

Contract signing

1. ELECTRONIC SIGNATURE

- 1.1 In this general condition “electronic signature” means a digital signature or a visual representation of a person’s handwritten signature or mark which is placed on a physical or electronic copy of this contract by electronic or mechanical means, and “electronically signed” has a corresponding meaning.
- 1.2 The parties consent to this contract being signed by or on behalf of a party by an electronic signature.
- 1.3 Where this contract is electronically signed by or on behalf of a party, the party warrants and agrees that the electronic signature has been used to identify the person signing and to indicate that the party intends to be bound by the electronic signature.
- 1.4 This contract may be electronically signed in any number of counterparts which together will constitute the one document.
- 1.5 Each party consents to the exchange of counterparts of this contract by delivery by email or such other electronic means as may be agreed in writing.
- 1.6 Each party must upon request promptly deliver a physical counterpart of this contract with the handwritten signature or signatures of the party and all written evidence of the authority of a person signing on their behalf, but a failure to comply with the request does not affect the validity of this contract.

2. LIABILITY OF SIGNATORY

Any signatory for a proprietary limited company purchaser is personally liable for the due performance of the purchaser’s obligations as if the signatory were the purchaser in the case of a default by a proprietary limited company purchaser.

3. GUARANTEE

The vendor may require one or more directors of the purchaser to guarantee the purchaser’s performance of this contract if the purchaser is a proprietary limited company.

4. NOMINEE

The purchaser may no later than 14 days before the due date for settlement nominate a substitute or additional person to take a transfer of the land, but the named purchaser remains personally liable for the due performance of all the purchase’s obligations under this contract.

Title

5. ENCUMBRANCES

- 5.1 The purchaser buys the property subject to:
 - (a) any encumbrance shown in the section 32 statement other than mortgages or caveats; and
 - (b) any reservations, exceptions and conditions in the crown grant; and
 - (c) any lease or tenancy referred to in the particulars of sale.
- 5.2 The purchaser indemnifies the vendor against all obligations under any lease or tenancy that are to be performed by the landlord after settlement.

6. VENDOR WARRANTIES

- 6.1 The vendor warrants that these general conditions 1 to 35 are identical to the general conditions 1 to 35 in the form of contract of sale of land published by the Law Institute of Victoria Limited and the Real Estate Institute of Victoria Pty Ltd in the month and year set out at the foot of this page.
- 6.2 The warranties in general conditions 6.3 and 6.4 replace the purchaser’s right to make requisitions and inquiries.
- 6.3 The vendor warrants that the vendor:
 - (a) has, or by the due date for settlement will have, the right to sell the land; and
 - (b) is under no legal disability; and
 - (c) is in possession of the land, either personally or through a tenant; and
 - (d) has not previously sold or granted any option to purchase, agreed to lease or granted a pre-emptive right which is current over the land and which gives another party rights which have priority over the interest of the purchaser; and
 - (e) will at settlement be the holder of an unencumbered estate in fee simple in the land; and
 - (f) will at settlement be the unencumbered owner of any improvements, fixtures, fittings and goods sold with the land.

- 6.4 The vendor further warrants that the vendor has no knowledge of any of the following:
- (a) public rights of way over the land;
 - (b) easements over the land;
 - (c) lease or other possessory agreement affecting the land;
 - (d) notice or order directly or indirectly affecting the land which will not be dealt with at settlement, other than the usual rate notices and any land tax notices;
 - (e) legal proceedings which would render the sale of the land void or voidable or capable of being set aside.
- 6.5 The warranties in general conditions 6.3 and 6.4 are subject to any contrary provisions in this contract and disclosures in the section 32 statement.
- 6.6 If sections 137B and 137C of the *Building Act* 1993 apply to this contract, the vendor warrants that:
- (a) all domestic building work carried out in relation to the construction by or on behalf of the vendor of the home was carried out in a proper and workmanlike manner; and
 - (b) all materials used in that domestic building work were good and suitable for the purpose for which they were used and that, unless otherwise stated in the contract, those materials were new; and
 - (c) domestic building work was carried out in accordance with all laws and legal requirements, including, without limiting the generality of this warranty, the *Building Act* 1993 and regulations made under the *Building Act* 1993.
- 6.7 Words and phrases used in general condition 6.6 which are defined in the *Building Act* 1993 have the same meaning in general condition 6.6.

7. IDENTITY OF THE LAND

- 7.1 An omission or mistake in the description of the property or any deficiency in the area, description or measurements of the land does not invalidate the sale.
- 7.2 The purchaser may not:
- (a) make any objection or claim for compensation for any alleged misdescription of the property or any deficiency in its area or measurements; or
 - (b) require the vendor to amend title or pay any cost of amending title.

8. SERVICES

- 8.1 The vendor does not represent that the services are adequate for the purchaser's proposed use of the property and the vendor advises the purchaser to make appropriate inquiries. The condition of the services may change between the day of sale and settlement and the vendor does not promise that the services will be in the same condition at settlement as they were on the day of sale.
- 8.2 The purchaser is responsible for the connection of all services to the property after settlement and the payment of any associated cost.

9. CONSENTS

The vendor must obtain any necessary consent or licence required for the vendor to sell the property. The contract will be at an end and all money paid must be refunded if any necessary consent or licence is not obtained by settlement.

10. TRANSFER & DUTY

- 10.1 The purchaser must prepare and deliver to the vendor at least 7 days before the due date for settlement any paper transfer of land document which is necessary for this transaction. The delivery of the transfer of land document is not acceptance of title.
- 10.2 The vendor must promptly initiate the Duties on Line or other form required by the State Revenue Office in respect of this transaction, and both parties must co-operate to complete it as soon as practicable.

11. RELEASE OF SECURITY INTEREST

- 11.1 This general condition applies if any part of the property is subject to a security interest to which the *Personal Property Securities Act* 2009 (Cth) applies.
- 11.2 For the purposes of enabling the purchaser to search the Personal Property Securities Register for any security interests affecting any personal property for which the purchaser may be entitled to a release, statement, approval or correction in accordance with general condition 11.4, the purchaser may request the vendor to provide the vendor's date of birth to the purchaser. The vendor must comply with a request made by the purchaser under this condition if the purchaser makes the request at least 21 days before the due date for settlement.
- 11.3 If the purchaser is given the details of the vendor's date of birth under condition 11.2, the purchaser must
- (a) only use the vendor's date of birth for the purposes specified in condition 11.2; and
 - (b) keep the date of birth of the vendor secure and confidential.

- 11.4 The vendor must ensure that at or before settlement, the purchaser receives –
- (a) a release from the secured party releasing the property from the security interest; or
 - (b) a statement in writing in accordance with section 275(1)(b) of the *Personal Property Securities Act 2009* (Cth) setting out that the amount or obligation that is secured is nil at settlement; or
 - (c) a written approval or correction in accordance with section 275(1)(c) of the *Personal Property Securities Act 2009* (Cth) indicating that, on settlement, the personal property included in the contract is not or will not be property in which the security interest is granted.
- 11.5 Subject to general condition 11.6, the vendor is not obliged to ensure that the purchaser receives a release, statement, approval or correction in respect of personal property –
- (a) that –
 - (i) the purchaser intends to use predominately for personal, domestic or household purposes; and
 - (ii) has a market value of not more than \$5000 or, if a greater amount has been prescribed for the purposes of section 47(1) of the *Personal Property Securities Act 2009* (Cth), not more than that prescribed amount; or
 - (b) that is sold in the ordinary course of the vendor's business of selling personal property of that kind.
- 11.6 The vendor is obliged to ensure that the purchaser receives a release, statement, approval or correction in respect of personal property described in general condition 11.5 if –
- (a) the personal property is of a kind that may be described by a serial number in the Personal Property Securities Register; or
 - (b) the purchaser has actual or constructive knowledge that the sale constitutes a breach of the security agreement that provides for the security interest.
- 11.7 A release for the purposes of general condition 11.4(a) must be in writing.
- 11.8 A release for the purposes of general condition 11.4(a) must be effective in releasing the goods from the security interest and be in a form which allows the purchaser to take title to the goods free of that security interest.
- 11.9 If the purchaser receives a release under general condition 11.4(a) the purchaser must provide the vendor with a copy of the release at or as soon as practicable after settlement.
- 11.10 In addition to ensuring a release is received under general condition 11.4(a), the vendor must ensure that at or before settlement the purchaser receives a written undertaking from a secured party to register a financing change statement to reflect that release if the property being released includes goods of a kind that are described by serial number in the Personal Property Securities Register.
- 11.11 The purchaser must advise the vendor of any security interest that is registered on or before the day of sale on the Personal Property Securities Register, which the purchaser reasonably requires to be released, at least 21 days before the due date for settlement.
- 11.12 The vendor may delay settlement until 21 days after the purchaser advises the vendor of the security interests that the purchaser reasonably requires to be released if the purchaser does not provide an advice under general condition 11.11.
- 11.13 If settlement is delayed under general condition 11.12, the purchaser must pay the vendor –
- (a) interest from the due date for settlement until the date on which settlement occurs or 21 days after the vendor receives the advice, whichever is the earlier; and
 - (b) any reasonable costs incurred by the vendor as a result of the delay – as though the purchaser was in default.
- 11.14 The vendor is not required to ensure that the purchaser receives a release in respect of the land. This general condition 11.14 applies despite general condition 11.1.
- 11.15 Words and phrases which are defined in the *Personal Property Securities Act 2009* (Cth) have the same meaning in general condition 11 unless the context requires otherwise.

12. BUILDING WARRANTY INSURANCE

The vendor warrants that the vendor will provide at settlement details of any current builder warranty insurance in the vendor's possession relating to the property if requested in writing to do so at least 21 days before settlement.

13. GENERAL LAW LAND

- 13.1 The vendor must complete a conversion of title in accordance with section 14 of the *Transfer of Land Act 1958* before settlement if the land is the subject of a provisional folio under section 23 of that Act.
- 13.2 The remaining provisions of this general condition 13 only apply if any part of the land is not under the operation of the *Transfer of Land Act 1958*.

- 13.3 The vendor is taken to be the holder of an unencumbered estate in fee simple in the land if there is an unbroken chain of title starting at least 30 years before the day of sale proving on the face of the documents the ownership of the entire legal and equitable estate without the aid of other evidence.
- 13.4 The purchaser is entitled to inspect the vendor's chain of title on request at such place in Victoria as the vendor nominates.
- 13.5 The purchaser is taken to have accepted the vendor's title if:
- (a) 21 days have elapsed since the day of sale; and
 - (b) the purchaser has not reasonably objected to the title or reasonably required the vendor to remedy a defect in the title.
- 13.6 The contract will be at an end if:
- (a) the vendor gives the purchaser a notice that the vendor is unable or unwilling to satisfy the purchaser's objection or requirement and that the contract will end if the objection or requirement is not withdrawn within 14 days of the giving of the notice; and
 - (b) the objection or requirement is not withdrawn in that time.
- 13.7 If the contract ends in accordance with general condition 13.6, the deposit must be returned to the purchaser and neither party has a claim against the other in damages.
- 13.8 General condition 17.1 [settlement] should be read as if the reference to 'registered proprietor' is a reference to 'owner' in respect of that part of the land which is not under the operation of the *Transfer of Land Act 1958*.
-

Money

14. DEPOSIT

- 14.1 The purchaser must pay the deposit:
- (a) to the vendor's licensed estate agent; or
 - (b) if there is no estate agent, to the vendor's legal practitioner or conveyancer; or
 - (c) if the vendor directs, into a special purpose account in an authorised deposit-taking institution in Victoria specified by the vendor in the joint names of the purchaser and the vendor.
- 14.2 If the land is sold on an unregistered plan of subdivision, the deposit:
- (a) must not exceed 10% of the price; and
 - (b) must be paid to the vendor's estate agent, legal practitioner or conveyancer and held by the estate agent, legal practitioner or conveyancer on trust for the purchaser until registration of the plan of subdivision.
- 14.3 The deposit must be released to the vendor if:
- (a) the vendor provides particulars, to the satisfaction of the purchaser; that either
 - (i) there are no debts secured against the property; or
 - (ii) if there are any debts, the total amount of those debts together with any amounts to be withheld in accordance with general conditions 24 and 25 does not exceed 80% of the sale price; and
 - (b) at least 28 days have elapsed since the particulars were given to the purchaser under paragraph (a); and
 - (c) all conditions of section 27 of the *Sale of Land Act 1962* have been satisfied.
- 14.4 The stakeholder must pay the deposit and any interest to the party entitled when the deposit is released, the contract is settled, or the contract is ended.
- 14.5 The stakeholder may pay the deposit and any interest into court if it is reasonable to do so.
- 14.6 Where the purchaser is deemed by section 27(7) of the *Sale of Land Act 1962* to have given the deposit release authorisation referred to in section 27(1), the purchaser is also deemed to have accepted title in the absence of any prior express objection to title.
- 14.7 Payment of the deposit may be made or tendered:
- (a) in cash up to \$1,000 or 0.2% of the price, whichever is greater; or
 - (b) by cheque drawn on an authorised deposit-taking institution; or
 - (c) by electronic funds transfer to a recipient having the appropriate facilities for receipt.
- However, unless otherwise agreed:

- (d) payments may not be made by credit card, debit card or any other financial transfer system that allows for any chargeback or funds reversal other than for fraud or mistaken payment, and
 - (e) any financial transfer or similar fees or deductions from the funds transferred, other than any fees charged by the recipient's authorised deposit-taking institution, must be paid by the remitter.
- 14.8 Payment by electronic transfer is made when cleared funds are received in the recipient's bank account.
- 14.9 Before the funds are electronically transferred the intended recipient must be notified in writing and given sufficient particulars to readily identify the relevant transaction.
- 14.10 As soon as the funds have been electronically transferred the intended recipient must be provided with the relevant transaction number or reference details.
- 14.11 For the purposes of this general condition 'authorised deposit-taking institution' means a body corporate for which an authority under section 9(3) of the *Banking Act 1959* (Cth) is in force.

15. DEPOSIT BOND

- 15.1 This general condition only applies if the applicable box in the particulars of sale is checked.
- 15.2 In this general condition "deposit bond" means an irrevocable undertaking to pay on demand an amount equal to the deposit or any unpaid part of the deposit. The issuer and the form of the deposit bond must be satisfactory to the vendor. The deposit bond must have an expiry date at least 45 days after the due date for settlement.
- 15.3 The purchaser may deliver a deposit bond to the vendor's estate agent, legal practitioner or conveyancer within 7 days after the day of sale.
- 15.4 The purchaser may at least 45 days before a current deposit bond expires deliver a replacement deposit bond on the same terms and conditions.
- 15.5 Where a deposit bond is delivered, the purchaser must pay the deposit to the vendor's legal practitioner or conveyancer on the first to occur of:
- (a) settlement;
 - (b) the date that is 45 days before the deposit bond or any replacement deposit bond expires;
 - (c) the date on which this contract ends in accordance with general condition 35.2 [default not remedied] following breach by the purchaser; and
 - (d) the date on which the vendor ends this contract by accepting repudiation of it by the purchaser.
- 15.6 The vendor may claim on the deposit bond without prior notice if the purchaser defaults under this contract or repudiates this contract and the contract is ended. The amount paid by the issuer satisfies the obligations of the purchaser under general condition 15.5 to the extent of the payment.
- 15.7 Nothing in this general condition limits the rights of the vendor if the purchaser defaults under this contract or repudiates this contract, except as provided in general condition 15.6.
- 15.8 This general condition is subject to general condition 14.2 [deposit].

16. BANK GUARANTEE

- 16.1 This general condition only applies if the applicable box in the particulars of sale is checked.
- 16.2 In this general condition:
- (a) "bank guarantee" means an unconditional and irrevocable guarantee or undertaking by a bank in a form satisfactory to the vendor to pay on demand any amount under this contract agreed in writing, and
 - (b) "bank" means an authorised deposit-taking institution under the *Banking Act 1959* (Cth).
- 16.3 The purchaser may deliver a bank guarantee to the vendor's legal practitioner or conveyancer.
- 16.4 The purchaser must pay the amount secured by the bank guarantee to the vendor's legal practitioner or conveyancer on the first to occur of:
- (a) settlement;
 - (b) the date that is 45 days before the bank guarantee expires;
 - (c) the date on which this contract ends in accordance with general condition 35.2 [default not remedied] following breach by the purchaser; and
 - (d) the date on which the vendor ends this contract by accepting repudiation of it by the purchaser.
- 16.5 The vendor must return the bank guarantee document to the purchaser when the purchaser pays the amount secured by the bank guarantee in accordance with general condition 16.4.
- 16.6 The vendor may claim on the bank guarantee without prior notice if the purchaser defaults under this contract or repudiates this contract and the contract is ended. The amount paid by the bank satisfies the obligations of the purchaser under general condition 16.4 to the extent of the payment.

- 16.7 Nothing in this general condition limits the rights of the vendor if the purchaser defaults under this contract or repudiates this contract except as provided in general condition 16.6.
- 16.8 This general condition is subject to general condition 14.2 [deposit].

17. SETTLEMENT

- 17.1 At settlement:
- (a) the purchaser must pay the balance; and
 - (b) the vendor must:
 - (i) do all things necessary to enable the purchaser to become the registered proprietor of the land; and
 - (ii) give either vacant possession or receipt of rents and profits in accordance with the particulars of sale.
- 17.2 Settlement must be conducted between the hours of 10.00 a.m. and 4.00 p.m. unless the parties agree otherwise.
- 17.3 The purchaser must pay all money other than the deposit in accordance with a written direction of the vendor or the vendor's legal practitioner or conveyancer.

18. ELECTRONIC SETTLEMENT

- 18.1 Settlement and lodgment of the instruments necessary to record the purchaser as registered proprietor of the land will be conducted electronically in accordance with the Electronic Conveyancing National Law. This general condition 18 has priority over any other provision of this contract to the extent of any inconsistency.
- 18.2 A party must immediately give written notice if that party reasonably believes that settlement and lodgment can no longer be conducted electronically. Special condition 18 ceases to apply from when such a notice is given.
- 18.3 Each party must:
- (a) be, or engage a representative who is, a subscriber for the purposes of the Electronic Conveyancing National Law,
 - (b) ensure that all other persons for whom that party is responsible and who are associated with this transaction are, or engage, a subscriber for the purposes of the Electronic Conveyancing National Law, and
 - (c) conduct the transaction in accordance with the Electronic Conveyancing National Law.
- 18.4 The vendor must open the electronic workspace ("workspace") as soon as reasonably practicable and nominate a date and time for settlement. The inclusion of a specific date for settlement in a workspace is not of itself a promise to settle on that date or at that time. The workspace is an electronic address for the service of notices and for written communications for the purposes of any electronic transactions legislation.
- 18.5 This general condition 18.5 applies if there is more than one electronic lodgment network operator in respect of the transaction. In this general condition 18.5 "the transaction" means this sale and purchase and any associated transaction involving any of the same subscribers.
- To the extent that any interoperability rules governing the relationship between electronic lodgment network operators do not provide otherwise:
- (a) the electronic lodgment network operator to conduct all the financial and lodgment aspects of the transaction after the workspace locks must be one which is willing and able to conduct such aspects of the transaction in accordance with the instructions of all the subscribers in the workspaces of all the electronic lodgment network operators after the workspace locks;
 - (b) if two or more electronic lodgment network operators meet that description, one may be selected by purchaser's incoming mortgagee having the highest priority but if there is no mortgagee of the purchaser, the vendor must make the selection.
- 18.6 Settlement occurs when the workspace records that:
- (a) there has been an exchange of funds or value between the exchange settlement account or accounts in the Reserve Bank of Australia of the relevant financial institutions or their financial settlement agents in accordance with the instructions of the parties; or
 - (b) if there is no exchange of funds or value, the documents necessary to enable the purchaser to become registered proprietor of the land have been accepted for electronic lodgment
- 18.7 The parties must do everything reasonably necessary to effect settlement:
- (a) electronically on the next business day; or
 - (b) at the option of either party, otherwise than electronically as soon as possible –
if, after the locking of the workspace at the nominated settlement time, settlement in accordance with special condition 18.6 has not occurred by 4.00 pm, or 6.00 pm if the nominated time for settlement is after 4.00 pm.
- 18.8 Each party must do everything reasonably necessary to assist the other party to trace and identify the recipient of any missing or mistaken payment and to recover the missing or mistaken payment.
- 18.9 The vendor must before settlement:
- (a) deliver any keys, security devices and codes ("keys") to the estate agent named in the contract,
 - (b) direct the estate agent to give the keys to the purchaser or the purchaser's nominee on notification of settlement by the vendor, the vendors subscriber or the electronic lodgment network operator,

- (c) deliver all other physical documents and items (other than the goods sold by the contract) to which the purchaser is entitled at settlement, and any keys if not delivered to the estate agent, to the vendor's subscriber or, if there is no vendor's subscriber, confirm in writing to the purchaser that the vendor holds those documents, items and keys at the vendor's address set out in the contract, and

give, or direct its subscriber to give, all those documents and items and any such keys to the purchaser or the purchaser's nominee on notification by the electronic lodgment network operator of settlement.

19. GST

- 19.1 The purchaser does not have to pay the vendor any amount in respect of GST in addition to the price if the particulars of sale specify that the price includes GST (if any).
- 19.2 The purchaser must pay to the vendor any GST payable by the vendor in respect of a taxable supply made under this contract in addition to the price if:
 - (a) the particulars of sale specify that GST (if any) must be paid in addition to the price; or
 - (b) GST is payable solely as a result of any action taken or intended to be taken by the purchaser after the day of sale, including a change of use; or
 - (c) the particulars of sale specify that the supply made under this contract is of land on which a 'farming business' is carried on and the supply (or part of it) does not satisfy the requirements of section 38-480 of the GST Act; or
 - (d) the particulars of sale specify that the supply made under this contract is of a going concern and the supply (or a part of it) does not satisfy the requirements of section 38-325 of the GST Act.
- 19.3 The purchaser is not obliged to pay any GST under this contract until a tax invoice has been given to the purchaser.
- 19.4 If the particulars of sale specify that the supply made under this contract is of land on which a 'farming business' is carried on:
 - (a) the vendor warrants that the property is land on which a farming business has been carried on for the period of 5 years preceding the date of supply; and
 - (b) the purchaser warrants that the purchaser intends that a farming business will be carried on after settlement on the property.
- 19.5 If the particulars of sale specify that the supply made under this contract is a 'going concern':
 - (a) the parties agree that this contract is for the supply of a going concern; and
 - (b) the purchaser warrants that the purchaser is, or prior to settlement will be, registered for GST; and
 - (c) the vendor warrants that the vendor will carry on the going concern until the date of supply.
- 19.6 If the particulars of sale specify that the supply made under this contract is a 'margin scheme' supply, the parties agree that the margin scheme applies to this contract.
- 19.7 In this general condition:
 - (a) 'GST Act' means *A New Tax System (Goods and Services Tax) Act 1999* (Cth); and
 - (b) 'GST' includes penalties and interest.

20. LOAN

- 20.1 If the particulars of sale specify that this contract is subject to a loan being approved, this contract is subject to the lender approving the loan on the security of the property by the approval date or any later date allowed by the vendor.
- 20.2 The purchaser may end the contract if the loan is not approved by the approval date, but only if the purchaser:
 - (a) immediately applied for the loan; and
 - (b) did everything reasonably required to obtain approval of the loan; and
 - (c) serves written notice ending the contract, together with written evidence of rejection or non-approval of the loan, on the vendor within 2 clear business days after the approval date or any later date allowed by the vendor; and
 - (d) is not in default under any other condition of this contract when the notice is given.
- 20.3 All money must be immediately refunded to the purchaser if the contract is ended.

21. BUILDING REPORT

- 21.1 This general condition only applies if the applicable box in the particulars of sales is checked.
- 21.2 The purchaser may end this contract within 14 days from the days of sale if the purchaser:
 - (a) obtains a written report from a registered building practitioner or architect which discloses a current defect in a structure on the land and designates it as a major building defect;
 - (b) gives the vendor a copy of the report and a written notice ending this contract; and
 - (c) is not in then in default.
- 21.3 All money paid must be immediately refunded to the purchaser if the contract ends in accordance with this general condition.

- 21.4 A notice under this general condition may be served on the vendor's legal practitioner, conveyancer or estate agent even if the estate agent's authority has formally expired at the time of service.
- 21.5 The registered building practitioner may inspect the property at any reasonable time for the purpose of preparing the report.

22. PEST REPORT

- 22.1 This general condition only applies if the applicable box in the particulars of sale is checked.
- 22.2 The purchaser may end this contract within 14 days from the day of sale if the purchaser:
 - (a) obtains a written report from a pest control operator licensed under Victorian law which discloses a current pest infestation on the land and designates it as a major infestation affecting the structure of a building on the land;
 - (b) gives the vendor a copy of the report and a written notice ending this contract; and
 - (c) is not then in default.
- 22.3 All money paid must be immediately refunded to the purchaser if the contract ends in accordance with this general condition.
- 22.4 A notice under this general condition may be served on the vendor's legal practitioner, conveyancer or estate agent even if the estate agent's authority has formally expired at the time of service.
- 22.5 The pest control operator may inspect the property at any reasonable time for the purpose of preparing the report.

23. ADJUSTMENTS

- 23.1 All periodic outgoings payable by the vendor, and any rent and other income received in respect of the property must be apportioned between the parties on the settlement date and any adjustment paid and received as appropriate.
- 23.2 The periodic outgoings and rent and other income must be apportioned on the following basis:
 - (a) the vendor is liable for the periodic outgoings and entitled to the rent and other income up to and including the day of settlement; and
 - (b) the land is treated as the only land of which the vendor is owner (as defined in the *Land Tax Act 2005*); and
 - (c) the vendor is taken to own the land as a resident Australian beneficial owner; and
 - (d) any personal statutory benefit available to each party is disregarded in calculating apportionment.
- 23.3 The purchaser must provide copies of all certificates and other information used to calculate the adjustments under general condition 23, if requested by the vendor.

24. FOREIGN RESIDENT CAPITAL GAINS WITHHOLDING

- 24.1 Words defined or used in Subdivision 14-D of Schedule 1 to the *Taxation Administration Act 1953* (Cth) have the same meaning in this general condition unless the context requires otherwise.
- 24.2 Every vendor under this contract is a foreign resident for the purposes of this general condition unless the vendor gives the purchaser a clearance certificate issued by the Commissioner under section 14-220 (1) of Schedule 1 to the *Taxation Administration Act 1953* (Cth). The specified period in the clearance certificate must include the actual date of settlement.
- 24.3 The remaining provisions of this general condition 24 only apply if the purchaser is required to pay the Commissioner an amount in accordance with section 14-200(3) or section 14-235 of Schedule 1 to the *Taxation Administration Act 1953* (Cth) ("the amount") because one or more of the vendors is a foreign resident, the property has or will have a market value not less than the amount set out in section 14-215 of the legislation just after the transaction, and the transaction is not excluded under section 14-215(1) of the legislation.
- 24.4 The amount is to be deducted from the vendor's entitlement to the contract consideration. The vendor must pay to the purchaser at settlement such part of the amount as is represented by non-monetary consideration.
- 24.5 The purchaser must:
 - (a) engage a legal practitioner or conveyancer ("representative") to conduct all legal aspects of settlement, including the performance of the purchaser's obligations under the legislation and this general condition; and
 - (b) ensure that the representative does so.
- 24.6 The terms of the representative's engagement are taken to include instructions to have regard to the vendor's interests and instructions that the representative must:
 - (a) pay, or ensure payment of, the amount to the Commissioner in the manner required by the Commissioner and as soon as reasonably and practicably possible, from moneys under the control or direction of the representative in accordance with this general condition if the sale of the property settles;
 - (b) promptly provide the vendor with proof of payment; and
 - (c) otherwise comply, or ensure compliance with, this general condition;
 despite:
 - (d) any contrary instructions, other than from both the purchaser and the vendor; and
 - (e) any other provision in this contract to the contrary.
- 24.7 The representative is taken to have complied with the requirements in special condition 24.6 if:
 - (a) the settlement is conducted through an electronic lodgement network; and

- (b) the amount is included in the settlement statement requiring payment to the Commissioner in respect of this transaction.
- 24.8 Any clearance certificate or document evidencing variation of the amount in accordance with section 14-235(2) of Schedule 1 to the *Taxation Administration Act 1953* (Cth) must be given to the purchaser at least 5 business days before the due date for settlement.
- 24.9 The vendor must provide the purchaser with such information as the purchaser requires to comply with the purchaser's obligation to pay the amount in accordance with section 14-200 of Schedule 1 to the *Taxation Administration Act 1953* (Cth). The information must be provided within 5 business days of request by the purchaser. The vendor warrants that the information the vendor provides is true and correct.
- 24.10 The purchaser is responsible for any penalties or interest payable to the Commissioner on account of late payment of the amount.

25. GST WITHHOLDING

- 25.1 Words and expressions defined or used in Subdivision 14-E of Schedule 1 to the *Taxation Administration Act 1953* (Cth) or in *A New Tax System (Goods and Services Tax) Act 1999* (Cth) have the same meaning in this general condition unless the context requires otherwise. Words and expressions first used in this general condition and shown in italics and marked with an asterisk are defined or described in at least one of those Acts.
- 25.2 The purchaser must notify the vendor in writing of the name of the recipient of the *supply for the purposes of section 14-255 of Schedule 1 to the *Taxation Administration Act 1953* (Cth) at least 21 days before the due date for settlement unless the recipient is the purchaser named in the contract.
- 25.3 The vendor must at least 14 days before the due date for settlement provide the purchaser and any person nominated by the purchaser under general condition 4 with GST withholding notice in accordance with section 14-255 of Schedule 1 to the *Taxation Administration Act 1953* (Cth), and must provide all information required by the purchaser or any person so nominated to confirm the accuracy of the notice.
- 25.4 The remaining provisions of this general condition 25 apply if the purchaser is or may be required to pay the Commissioner an *amount in accordance with section 14-250 of Schedule 1 to the *Taxation Administration Act 1953* (Cth) because the property is *new residential premise or *potential residential land in either case falling within the parameters of that section, and also if the sale attracts the operation of section 14-255 of the legislation. Nothing in this general condition 25 is to be taken as relieving the vendor from compliance with section 14-255.
- 25.5 The amount is to be deducted from the vendor's entitlement to the contract *consideration and is then taken to be paid to the vendor, whether or not the vendor provides the purchaser with a GST withholding notice in accordance with section 14-255 of Schedule 1 to the *Taxation Administration Act 1953* (Cth). The vendor must pay to the purchaser at settlement such part of the amount as is represented by non-monetary consideration.
- 25.6 The purchaser must:
 - (a) engage a legal practitioner or conveyancer ("representative") to conduct all the legal aspects of settlement, including the performance of the purchaser's obligations under the legislation and this general condition; and
 - (b) ensure that the representative does so.
- 25.7 The terms of the representative's engagement are taken to include instructions to have regard to the vendor's interests relating to the payment of the amount to the Commissioner and instructions that the representative must:
 - (a) pay, or ensure payment of, the amount to the Commissioner in the manner required by the Commissioner and as soon as reasonably and practicably possible, from moneys under the control or direction of the representative in accordance with this general condition on settlement of the sale of the property;
 - (b) promptly provide the vendor with evidence of payment, including any notification or other document provided by the purchaser to the Commissioner relating to payment; and
 - (c) otherwise comply, or ensure compliance, with this general condition;
 despite:
 - (d) any contrary instructions, other than from both the purchaser and the vendor; and
 - (e) any other provision in this contract to the contrary.
- 25.8 The representative is taken to have complied with the requirements of general condition 25.7 if:
 - (a) settlement is conducted through the electronic lodgement network; and
 - (b) the amount is included in the settlement statement requiring payment to the Commissioner in respect of this transaction.
- 25.9 The purchaser may at settlement give the vendor a bank cheque for the amount in accordance with section 16-30 (3) of Schedule 1 to the *Taxation Administration Act 1953* (Cth), but only if:
 - (a) so agreed by the vendor in writing; and
 - (b) the settlement is not conducted through an electronic lodgement network.
 However, if the purchaser gives the bank cheque in accordance with this general condition 25.9, the vendor must:
 - (c) immediately after settlement provide the bank cheque to the Commissioner to pay the amount in relation to the supply; and

- (d) give the purchaser a receipt for the bank cheque which identifies the transaction and includes particulars of the bank cheque, at the same time the purchaser gives the vendor the bank cheque.
- 25.10 A party must provide the other party with such information as the other party requires to:
- (a) decide if an amount is required to be paid or the quantum of it, or
- (b) comply with the purchaser's obligation to pay the amount,
- in accordance with section 14-250 of Schedule 1 to the *Taxation Administration Act 1953* (Cth). The information must be provided within 5 business days of a written request. The party providing the information warrants that it is true and correct.
- 25.11 The vendor warrants that:
- (a) at settlement, the property is not new residential premises or potential residential land in either case falling within the parameters of section 14-250 of Schedule 1 to the *Taxation Administration Act 1953* (Cth) if the vendor gives the purchaser a written notice under section 14-255 to the effect that the purchaser will not be required to make a payment under section 14-250 in respect of the supply, or fails to give a written notice as required by and within the time specified in section 14-255; and
- (b) the amount described in a written notice given by the vendor to the purchaser under section 14-255 of Schedule 1 to the *Taxation Administration Act 1953* (Cth) is the correct amount required to be paid under section 14-250 of the legislation.
- 25.12 The purchaser is responsible for any penalties or interest payable to the Commissioner on account of non-payment or late payment of the amount, except to the extent that:
- (a) the penalties or interest arise from any failure on the part of the vendor, including breach of a warranty in general condition 25.11; or
- (b) the purchaser's reasonable belief that the property is neither new residential premises nor potential residential land requiring the purchaser to pay an amount to the Commissioner in accordance with section 14-250 (1) of Schedule 1 to the *Taxation Administration Act 1953* (Cth)
- The vendor is responsible for any penalties or interest payable to the Commissioner on account of non-payment or late payment of the amount if either exception applies.
-

Transactional

26. TIME & CO OPERATION

- 26.1 Time is of the essence of this contract.
- 26.2 Time is extended until the next business day if the time for performing any action falls on a day which is not a business day.
- 26.3 Each party must do all things reasonably necessary to enable this contract to proceed to settlement, and must act in a prompt and efficient manner.
- 26.4 Any unfulfilled obligation will not merge on settlement.

27. SERVICE

- 27.1 Any document required to be served by or on any party may be served by or on the legal practitioner or conveyancer for that party.
- 27.2 A cooling off notice under section 31 of the *Sale of Land Act 1962* or a notice under general condition 20 [loan approval], 21 [building report] or 22 [pest report] may be served on the vendor's legal practitioner, conveyancer or estate agent even if the estate agent's authority has formally expired at the time of service.
- 27.3 A document is sufficiently served:
- (a) personally; or
- (b) by pre-paid post; or
- (c) in any manner authorised by law or by the Supreme Court for service of documents, including any manner authorised for service on or by a legal practitioner; whether or not the person serving or receiving the document is a legal practitioner, or
- (d) by email.
- 27.4 Any document properly sent by:
- (a) express post is taken to have been served on the next business day after posting, unless proved otherwise;
- (b) priority post is taken to have been served on the fourth business day after posting, unless proved otherwise;
- (c) regular post is taken to have been served on the sixth business day after posting, unless proved otherwise;
- (d) email is taken to have been served at the time of receipt within the meaning of section 13A of the *Electronic Transactions (Victoria) Act 2000*.
- 27.5 In this contract 'document' includes 'demand' and 'notice', 'serve' includes 'give' and 'served' and 'service' have corresponding meanings.

28. NOTICES

- 28.1 The vendor is responsible for any notice, order, demand or levy imposing liability on the property that is issued or made before the day of sale, and does not relate to periodic outgoings.
- 28.2 The purchaser is responsible for any notice, order, demand or levy imposing liability on the property that is issued or made on or after the day of sale that does not relate to periodic outgoings.
- 28.3 The purchaser may enter the property to comply with that responsibility where action is required before settlement.

29. INSPECTION

The purchaser and/or another person authorised by the purchaser may inspect the property at any reasonable time during the 7 days preceding and including the settlement day.

30. TERMS CONTRACT

- 30.1 If this is a 'terms contract' as defined in the *Sale of Land Act 1962*:
 - (a) any mortgage affecting the land sold must be discharged as to that land before the purchaser becomes entitled to possession or to the receipt of rents and profits unless the vendor satisfies section 29M of the Sale of Land Act 1962; and
 - (b) the deposit and all other money payable under the contract (other than any money payable in excess of the amount required to so discharge the mortgage) must be paid to a legal practitioner or conveyancer or a licensed estate agent to be applied in or towards discharging the mortgage.
- 30.2 While any money remains owing each of the following applies:
 - (a) the purchaser must maintain full damage and destruction insurance of the property and public risk insurance noting all parties having an insurable interest with an insurer approved in writing by the vendor;
 - (b) the purchaser must deliver copies of the signed insurance application forms, the policies and the insurance receipts to the vendor not less than 10 days before taking possession of the property or becoming entitled to receipt of the rents and profits;
 - (c) the purchaser must deliver copies of any amendments to the policies and the insurance receipts on each amendment or renewal as evidence of the status of the policies from time to time;
 - (d) the vendor may pay any renewal premiums or take out the insurance if the purchaser fails to meet these obligations;
 - (e) insurance costs paid by the vendor under paragraph (d) must be refunded by the purchaser on demand without affecting the vendor's other rights under this contract;
 - (f) the purchaser must maintain and operate the property in good repair (fair wear and tear excepted) and keep the property safe, lawful, structurally sound, weatherproof and free from contaminations and dangerous substances;
 - (g) the property must not be altered in any way without the written consent of the vendor which must not be unreasonably refused or delayed;
 - (h) the purchaser must observe all obligations that affect owners or occupiers of land;
 - (i) the vendor and/or other person authorised by the vendor may enter the property at any reasonable time to inspect it on giving 7 days written notice, but not more than twice in a year.

31. LOSS OR DAMAGE BEFORE SETTLEMENT

- 31.1 The vendor carries the risk of loss or damage to the property until settlement.
- 31.2 The vendor must deliver the property to the purchaser at settlement in the same condition it was in on the day of sale, except for fair wear and tear.
- 31.3 The purchaser must not delay settlement because one or more of the goods is not in the condition required by general condition 31.2, but may claim compensation from the vendor after settlement.
- 31.4 The purchaser may nominate an amount not exceeding \$5,000 to be held by a stakeholder to be appointed by the parties if the property is not in the condition required by general condition 31.2 at settlement.
- 31.5 The nominated amount may be deducted from the amount due to the vendor at settlement and paid to the stakeholder, but only if the purchaser also pays an amount equal to the nominated amount to the stakeholder.
- 31.6 The stakeholder must pay the amounts referred to in general condition 31.5 in accordance with the determination of the dispute, including any order for payment of the costs of the resolution of the dispute.

32. BREACH

A party who breaches this contract must pay to the other party on demand:

- (a) compensation for any reasonably foreseeable loss to the other party resulting from the breach; and
- (b) any interest due under this contract as a result of the breach.

Default

33. INTEREST

Interest at a rate of 2% per annum plus the rate for the time being fixed by section 2 of the *Penalty Interest Rates Act* 1983 is payable at settlement on any money owing under the contract during the period of default, without affecting any other rights of the offended party.

34. DEFAULT NOTICE

- 34.1 A party is not entitled to exercise any rights arising from the other party's default, other than the right to receive interest and the right to sue for money owing, until the other party is given and fails to comply with a written default notice.
- 34.2 The default notice must:
- (a) specify the particulars of the default; and
 - (b) state that it is the offended party's intention to exercise the rights arising from the default unless, within 14 days of the notice being given-
 - (i) the default is remedied; and
 - (ii) the reasonable costs incurred as a result of the default and any interest payable are paid.

35. DEFAULT NOT REMEDIED

- 35.1 All unpaid money under the contract becomes immediately payable to the vendor if the default has been made by the purchaser and is not remedied and the costs and interest are not paid.
- 35.2 The contract immediately ends if:
- (a) the default notice also states that unless the default is remedied and the reasonable costs and interest are paid, the contract will be ended in accordance with this general condition; and
 - (b) the default is not remedied and the reasonable costs and interest are not paid by the end of the period of the default notice.
- 35.3 If the contract ends by a default notice given by the purchaser:
- (a) the purchaser must be repaid any money paid under the contract and be paid any interest and reasonable costs payable under the contract; and
 - (b) all those amounts are a charge on the land until payment; and
 - (c) the purchaser may also recover any loss otherwise recoverable.
- 35.4 If the contract ends by a default notice given by the vendor:
- (a) the deposit up to 10% of the price is forfeited to the vendor as the vendor's absolute property, whether the deposit has been paid or not; and
 - (b) the vendor is entitled to possession of the property; and
 - (c) in addition to any other remedy, the vendor may within one year of the contract ending either:
 - (i) retain the property and sue for damages for breach of contract; or
 - (ii) resell the property in any manner and recover any deficiency in the price on the resale and any resulting expenses by way of liquidated damages; and
 - (d) the vendor may retain any part of the price paid until the vendor's damages have been determined and may apply that money towards those damages; and
 - (e) any determination of the vendor's damages must take into account the amount forfeited to the vendor.
- 35.5 The ending of the contract does not affect the rights of the offended party as a consequence of the default.
-

GUARANTEE AND INDEMNITY

TO: The withinnamed and described Vendor
(hereinafter called "the Vendor")

IN CONSIDERATION of the Vendor having at the request of the person whose name address and description are set forth in the Schedule hereto (hereinafter called "the Guarantor") agreed to sell the land described in the within Contract of Sale to the withinnamed Purchaser (hereinafter called "the Purchaser") the Guarantor HEREBY GUARANTEES to the Vendor the due and punctual payment by the Purchaser of the purchase money and interest payable thereon as detailed in the said Contract of Sale and all other monies that are payable or may become payable pursuant thereto (hereinafter called "the monies hereby secured") AND ALSO the due performance and observance by the Purchaser of all and singular the covenants provisions and stipulations contained or implied in the said Contract of Sale and on the part of the Purchaser to be performed and observed AND THE GUARANTOR HEREBY EXPRESSLY ACKNOWLEDGES AND DECLARES that it has examined the said Contract of Sale and has access to a copy thereof and further that this Guarantee is given upon and subject to the following conditions:-

- A. THAT in the event of the Purchaser failing to pay the Vendor as and when due the monies referred to in the within Contract the Guarantor will immediately pay such monies to the Vendor.
- B. THAT in the event of the Purchaser failing to carry out or perform any of its obligations under the said Contract the Guarantor will immediately carry out and perform the same.
- C. THE Guarantor shall be deemed to be jointly and severally liable with the Purchaser (in lieu of being merely a surety for it) for the payment of the purchase moneys interest and all other monies if any payable pursuant to the within Contract in the performance of the obligations herein contained and it shall not be necessary for the Vendor to make any claim or demand on or to take any action or proceedings against the Purchaser before calling on the Guarantor to pay the moneys or to carry out and perform the obligations herein contained.
- D. THAT no time or other indulgence whatsoever that may be granted by the Vendor to the Purchaser shall in any manner whatsoever affect a liability of the Guarantor hereunder and the liability of the Guarantor shall continue to remain in full force and effect until all monies owing to the Vendor have been paid and all obligations have been performed.

SCHEDULE

Vendor: Bradley Rupert Bibby

Purchaser:

Guarantor:

IN WITNESS WHEREOF the said Guarantors have set their hands and seals
this _____ day of _____

2025.

SIGNED SEALED AND DELIVERED by _____)
the said Guarantor _____)
in Victoria in the presence of: _____)

INTENTIONALLY BLANK

DATED

2025

BRADLEY RUPERT BIBBY

to

CONTRACT OF SALE OF LAND

Property: Stawell-Avoca Road, Barkly 3384

MCL LEGAL

78 Napier Street
St Arnaud Vic 3478

Tel: 03 5495 1033
Ref: ML:JM:250228

Vendor Statement

The vendor makes this statement in respect of the land in accordance with section 32 of the *Sale of Land Act 1962*.

This statement must be signed by the vendor and given to the purchaser before the purchaser signs the contract.

The vendor may sign by electronic signature.

The purchaser acknowledges being given this statement signed by the vendor with the attached documents before the purchaser signed any contract.

Land

Stawell-Avoca Road, Barkly

Vendor's name

Bradley Rupert Bibby

Date

29/9/25

**Vendor's
signature**



**Purchaser's
name**

Date

/ /

**Purchaser's
signature**

**Purchaser's
name**

Date

/ /

**Purchaser's
signature**

1 FINANCIAL MATTERS

1.1 Particulars of any Rates, Taxes, Charges or Other Similar Outgoings (and any interest on them)

(a) Their amounts are:

Authority	Amount	Interest (if any)
(1) Pyrenees Shire Council	(1) \$4,105.66 (2025/26)	(1)
(2)	(2)	(2)
(3)	(3)	(3)

1.2 Particulars of any Charge (whether registered or not) imposed by or under any Act to secure an amount due under that Act, including the amount owing under the charge

	To	
Other particulars (including dates and times of payments): None to the Vendor's knowledge		

1.3 Terms Contract

This section 1.3 only applies if this vendor statement is in respect of a terms contract where the purchaser is obliged to make 2 or more payments (other than a deposit or final payment) to the vendor after the execution of the contract and before the purchaser is entitled to a conveyance or transfer of the land.

Not Applicable.

1.4 Sale Subject to Mortgage

This section 1.4 only applies if this vendor statement is in respect of a contract which provides that any mortgage (whether registered or unregistered), is NOT to be discharged before the purchaser becomes entitled to possession or receipts of rents and profits.

Not Applicable.

1.5 Commercial and Industrial Property Tax Reform Act 2024 (Vic) (CIPT Act)

(a) The Australian Valuation Property Classification Code (within the meaning of the CIPT Act) most recently allocated to the land is set out in the attached Municipal rates notice or property clearance certificate or is as follows	AVPCC No. 530 – Mixed farming and grazing
(b) Is the land tax reform scheme land within the meaning of the CIPT Act?	<input type="checkbox"/> Yes <input checked="" type="checkbox"/> No
(c) If the land is tax reform scheme land within the meaning of the CIPT Act, the entry date within the meaning of the CIPT Act is set out in the attached Municipal rates notice of property clearance certificate or is as follows	Date: OR <input checked="" type="checkbox"/> Not applicable

2 INSURANCE

2.1 Damage and Destruction

This section 2.1 only applies if this vendor statement is in respect of a contract which does NOT provide for the land to remain at the risk of the vendor until the purchaser becomes entitled to possession or receipt of rents and profits.

Not Applicable.

2.2 Owner Builder

This section 2.2 only applies where there is a residence on the land that was constructed by an owner-builder within the preceding 6 years and section 137B of the *Building Act* 1993 applies to the residence.

Not Applicable.

3 LAND USE

3.1 Easements, Covenants or Other Similar Restrictions

- (a) A description of any easement, covenant or other similar restriction affecting the land (whether registered or unregistered): -
Not Applicable.

3.2. Road Access

There is NO access to the property by road if the square box is marked with an 'X'

☐

3.3. Designated Bushfire Prone Area

The land is in a designated bushfire prone area under section 192A of the *Building Act* 1993 if the square box is marked with an 'X'

☒

3.4. Planning Scheme

The required specified information is as follows:

Name of planning scheme
Name of responsible authority
Zoning of the land
Name of planning overlay

PYRENEES PLANNING SCHEME
PYRENEES SHIRE COUNCIL
FARMING ZONE
DESIGN AND DEVELOPMENT OVERLAY RESTRUCTURE OVERLAY BUSHFIRE MANAGEMENT OVERLAY

4 NOTICES

4.1. Notice, Order, Declaration, Report or Recommendation

Particulars of any notice, order, declaration, report or recommendation of a public authority or government department or approved proposal directly and currently affecting the land, being a notice, order, declaration, report, recommendation or approved proposal of which the vendor might reasonably be expected to have knowledge:

Not Applicable.

4.2. Agricultural Chemicals

There are NO notices, property management plans, reports or orders in respect of the land issued by a government department or public authority in relation to livestock disease or contamination by agricultural chemicals affecting the ongoing use of the land for agricultural purposes. However, if this is not the case, the details of any such notices, property management plans, reports or orders, are as follows:

Not Applicable.

4.3. Compulsory Acquisition

The particulars of any notices of intention to acquire that have been served under section 6 of the *Land Acquisition and Compensation Act* 1986 are as follows:

Not Applicable.

5 BUILDING PERMITS

Particulars of any building permit issued under the *Building Act* 1993 in the preceding 7 years (required only where there is a residence on the land):

Not Applicable.

6 OWNERS CORPORATION

This section 6 only applies if the land is affected by an owners corporation within the meaning of the *Owners Corporations Act* 2006.

Not Applicable.

7 GROWTH AREAS INFRASTRUCTURE CONTRIBUTION (“GAIC”)

Not Applicable.

8 SERVICES

The services which are marked with an 'X' in the accompanying square box are NOT connected to the land:

Electricity supply <input checked="" type="checkbox"/>	Gas supply <input checked="" type="checkbox"/>	Water supply <input checked="" type="checkbox"/>	Sewerage <input checked="" type="checkbox"/>	Telephone services <input checked="" type="checkbox"/>
--	--	--	--	--

9 TITLE

Attached are copies of the following documents:

9.1 (a) Registered Title

A Register Search Statement and the document, or part of a document, referred to as the 'diagram location' in that statement which identifies the land and its location.

10 SUBDIVISION

10.1. Unregistered Subdivision

This section 10.1 only applies if the land is subject to a subdivision which is not registered.

Not Applicable.

10.2. Staged Subdivision

This section 10.2 only applies if the land is part of a staged subdivision within the meaning of section 37 of the *Subdivision Act 1988*.

Not Applicable.

10.3. Further Plan of Subdivision

This section 10.3 only applies if the land is subject to a subdivision in respect of which a further plan within the meaning of the *Subdivision Act 1988* is proposed.

Not Applicable.

11 DISCLOSURE OF ENERGY INFORMATION

(Disclosure of this information is not required under section 32 of the Sale of Land Act 1962 but may be included in this vendor statement for convenience.)

Details of any energy efficiency information required to be disclosed regarding a disclosure affected building or disclosure area affected area of a building as defined by the *Building Energy Efficiency Disclosure Act 2010* (Cth)

- (a) to be a building or part of a building used or capable of being used as an office for administrative, clerical, professional or similar based activities including any support facilities; and
- (b) which has a net lettable area of at least 1000m²; (but does not include a building under a strata title system or if an occupancy permit was issued less than 2 years before the relevant date);

Not Applicable.

12 DUE DILIGENCE CHECKLIST

(The Sale of Land Act 1962 provides that the vendor or the vendor's licensed estate agent must make a prescribed due diligence checklist available to purchasers before offering land for sale that is vacant residential land or land on which there is a residence. The due diligence checklist is NOT required to be provided with, or attached to, this vendor statement but the checklist may be attached as a matter of convenience.)

- ☐ Vacant Residential Land or Land with a Residence
- ☒ Attach Due Diligence Checklist (this will be attached if ticked)

13 ATTACHMENTS

(Any certificates, documents and other attachments may be annexed to this section 13)

(Additional information may be added to this section 13 where there is insufficient space in any of the earlier sections)

(Attached is an "Additional Vendor Statement" if section 1.3 (Terms Contract) or section 1.4 (Sale Subject to Mortgage) applies)

Register Search Statements, Title Plans, Land VIC Property and Planning Reports, Crown Land Ag Licences

Copyright State of Victoria. No part of this publication may be reproduced except as permitted by the Copyright Act 1968 (Cth), to comply with a statutory requirement or pursuant to a written agreement. The information is only valid at the time and in the form obtained from the LANDATA REGD TM System. None of the State of Victoria, its agents or contractors, accepts responsibility for any subsequent publication or reproduction of the information.

The Victorian Government acknowledges the Traditional Owners of Victoria and pays respects to their ongoing connection to their Country, History and Culture. The Victorian Government extends this respect to their Elders, past, present and emerging.

REGISTER SEARCH STATEMENT (Title Search) Transfer of Land Act 1958

VOLUME 02869 FOLIO 737

Security no : 124127391525E
Produced 22/08/2025 11:21 AM

CROWN GRANT

LAND DESCRIPTION

Crown Allotment 46 Section D Parish of Barkly.

REGISTERED PROPRIETOR

Estate Fee Simple

Sole Proprietor

BRADLEY RUPERT BIBBY of 1006 BARKLY ROAD NAVARRE VIC 3384
AN258660F 09/11/2016

ENCUMBRANCES, CAVEATS AND NOTICES

MORTGAGE AN258662B 09/11/2016

AUSTRALIA AND NEW ZEALAND BANKING GROUP LTD

Any crown grant reservations exceptions conditions limitations and powers noted on the plan or imaged folio set out under DIAGRAM LOCATION below.
For details of any other encumbrances see the plan or imaged folio set out under DIAGRAM LOCATION below.

DIAGRAM LOCATION

SEE TP527328N FOR FURTHER DETAILS AND BOUNDARIES

ACTIVITY IN THE LAST 125 DAYS

NIL

-----END OF REGISTER SEARCH STATEMENT-----

Additional information: (not part of the Register Search Statement)

Street Address: STAWELL-AVOCA ROAD BARKLY VIC 3384

See MI303370T for WATER FRONTAGE LICENCE details

ADMINISTRATIVE NOTICES

NIL

eCT Control 15314Q ANZ RETAIL BANKING
Effective from 09/11/2016

DOCUMENT END

Delivered from the LANDATA® System by InfoTrack Pty Ltd.

The information supplied by InfoTrack (LEAP) has been obtained from InfoTrack Pty Limited by agreement between them. The information supplied has been obtained by InfoTrack Pty Limited who is licensed by the State of Victoria to provide this information via LANDATA® System.

TITLE PLAN		EDITION 1	TP 527328N
Location of Land		<div>Notations</div> <div>SUBJECT TO THE RESERVATIONS EXCEPTIONS CONDITIONS AND POWERS CONTAINED IN CROWN GRANT VOL. 2869 FOL. 737 AND NOTED ON SHEET 2 OF THIS PLAN</div> <div>WATERWAY NOTATION: LAND IN THIS PLAN MAY ABUT CROWN LAND THAT MAY BE SUBJECT TO A CROWN LICENCE TO USE</div> <div>THE RESERVE IS NOT WITHIN THE FEE OF THE TITLE</div> <div>ANY REFERENCE TO MAP IN THE TEXT MEANS THE DIAGRAM SHOWN ON THIS TITLE PLAN</div>	
Parish: BARKLY Township: Section: D Crown Allotment: 46 Crown Portion: Last Plan Reference: Derived From: VOL 2869 FOL 737 Depth Limitation: NIL		Description of Land / Easement Information	
		<div>THIS PLAN HAS BEEN PREPARED FOR THE LAND REGISTRY, LAND VICTORIA, FOR TITLE DIAGRAM PURPOSES AS PART OF THE LAND TITLES AUTOMATION PROJECT</div> <div>COMPILED: 12/06/2000</div> <div>VERIFIED: CL</div>	
		<div>COLOUR CODE</div> <div>Y = YELLOW</div>	
LENGTHS ARE IN LINKS		Metres = 0.3048 x Feet Metres = 0.201168 x Links	Sheet 1 of 2 sheets

TITLE PLAN		TP 527328N	
<div>LAND DESCRIPTION INCLUDING RESERVATIONS EXCEPTIONS CONDITIONS AND POWERS SHOWN ON THE CROWN GRANT</div> <div><p>All THAT PIECE OF LAND in the said State containing <i>three hundred and ninety six and thirteen perches more or less</i> <i>being Attachment forty six of Section D in the Parish of Barkly County of Kara Kara</i></p><p>delimited with the measurements and abutments thereof in the map drawn in the margin of these presents and therein coloured yellow</p><p>EXCEPTING however unto us our heirs and successors all gold and silver and auriferous and argentiferous earth or stone and all mines containing gold silver copper tin antimony coal lignite and all other metals and mineral ores whatsoever and all mines seams lodes or deposits containing gold silver copper tin antimony coal lignite and other metals and minerals and mineral ores in upon or under and within the boundaries of the said land AND ALSO reserving to us our heirs and successors free liberty and authority for us our heirs and successors and our and their agents and servants at any time or times hereafter to enter upon the said land and to search and mine therein for gold silver copper tin antimony coal lignite and other metals and minerals and mineral ores and to extract and remove therefrom any gold silver and any auriferous and argentiferous earth or stone copper tin antimony coal lignite and other metals and minerals and mineral ores and to search for and work dispose of and carry away the gold silver copper tin antimony coal lignite metals minerals and their ores and the mines metals and minerals in upon and under the land hereby granted and for the purposes aforesaid to sink shafts erect machinery carry on any works and do any other things which may be necessary or usual in mining PROVIDED ALWAYS that it shall be lawful for us our heirs and successors at any time on paying full compensation to the said GRANTEE</p><p>his heirs executors administrators or assigns for the full value other than that due to any metals or minerals or mineral ores being thereon or thereunder of the said piece of land or so much thereof as may be resumed as hereinafter mentioned and of the improvements upon the said piece of land or the part so resumed such value in case of disagreement to be ascertained by arbitration to resume the said piece of land or any part thereof for mining purposes AND THAT the terms conditions and events upon which such land may be resumed and the manner in which such arbitration may be conducted may be determined by regulations in such manner as the Governor in Council may from time to time direct or if at any time no such regulations shall be in force then by the regulations concerning the resumption of land for mining purposes in force at the date of this Grant unless Parliament shall otherwise determine.</p></div>			
LENGTHS ARE IN LINKS		Metres = 0.3946 x Feet Metres = 0.201168 x Links	Sheet 2 of 2 sheets

Copyright State of Victoria. No part of this publication may be reproduced except as permitted by the Copyright Act 1968 (Cth), to comply with a statutory requirement or pursuant to a written agreement. The information is only valid at the time and in the form obtained from the LANDATA REGD TM System. None of the State of Victoria, its agents or contractors, accepts responsibility for any subsequent publication or reproduction of the information.

The Victorian Government acknowledges the Traditional Owners of Victoria and pays respects to their ongoing connection to their Country, History and Culture. The Victorian Government extends this respect to their Elders, past, present and emerging.

REGISTER SEARCH STATEMENT (Title Search) Transfer of Land Act 1958

VOLUME 03048 FOLIO 465

Security no : 124127391523G
Produced 22/08/2025 11:21 AM

CROWN GRANT

LAND DESCRIPTION

Crown Allotment 45 Section D Parish of Barkly.

REGISTERED PROPRIETOR

Estate Fee Simple

Sole Proprietor

BRADLEY RUPERT BIBBY of 1006 BARKLY ROAD NAVARRE VIC 3384
AN258660F 09/11/2016

ENCUMBRANCES, CAVEATS AND NOTICES

MORTGAGE AN258662B 09/11/2016

AUSTRALIA AND NEW ZEALAND BANKING GROUP LTD

Any crown grant reservations exceptions conditions limitations and powers noted on the plan or imaged folio set out under DIAGRAM LOCATION below.
For details of any other encumbrances see the plan or imaged folio set out under DIAGRAM LOCATION below.

DIAGRAM LOCATION

SEE TP416140C FOR FURTHER DETAILS AND BOUNDARIES

ACTIVITY IN THE LAST 125 DAYS

NIL

-----END OF REGISTER SEARCH STATEMENT-----

Additional information: (not part of the Register Search Statement)

Street Address: STAWELL-AVOCA ROAD BARKLY VIC 3384

ADMINISTRATIVE NOTICES

NIL

eCT Control 15314Q ANZ RETAIL BANKING
Effective from 09/11/2016

DOCUMENT END

Delivered from the LANDATA® System by InfoTrack Pty Ltd.

The information supplied by InfoTrack (LEAP) has been obtained from InfoTrack Pty Limited by agreement between them. The information supplied has been obtained by InfoTrack Pty Limited who is licensed by the State of Victoria to provide this information via LANDATA® System.

TITLE PLAN		EDITION 1	TP 416140C
Location of Land Parish: BARKLY Township: Section: D Crown Allotment: 45 Crown Portion: Last Plan Reference: Derived From: VOL 3048 FOL 465 Depth Limitation: NIL		Notations SUBJECT TO THE RESERVATIONS EXCEPTIONS CONDITIONS AND POWERS CONTAINED IN CROWN GRANT VOL. 3048 FOL. 465 AND NOTED ON SHEET 2 OF THIS PLAN ANY REFERENCE TO MAP IN THE TEXT MEANS THE DIAGRAM SHOWN ON THIS TITLE PLAN	
Description of Land / Easement Information		THIS PLAN HAS BEEN PREPARED FOR THE LAND REGISTRY, LAND VICTORIA, FOR TITLE DIAGRAM PURPOSES AS PART OF THE LAND TITLES AUTOMATION PROJECT COMPILED: 20/04/2000 VERIFIED: GB	
		COLOUR CODE Y = YELLOW	
LENGTHS ARE IN LINKS		Metres = 0.3048 x Feet Metres = 0.201168 x Links	Sheet 1 of 2 sheets

TITLE PLAN		TP 416140C	
LAND DESCRIPTION INCLUDING RESERVATIONS EXCEPTIONS CONDITIONS AND POWERS SHOWN ON THE CROWN GRANT			
<p>ALL THAT PIECE OF LAND is the said State containing <i>One hundred and eighty three acres and nineteen perches more or less being Allotment forty five of Section D in the Parish of Baskly County of Kera Kera</i></p> <p>delineated with the measurements and abutments thereof in the map drawn in the margin of these presents and therein coloured yellow</p> <p>EXCEPTED however unto us our heirs and successors all gold and silver and auriferous and argentiferous earth or stone and all mines containing gold silver copper tin antimony coal lignite and all other metals and mineral ores whatsoever and all mines seams lodes or deposits containing gold silver copper tin antimony coal lignite and other metals and minerals and mineral ores in upon or under and within the boundaries of the said land AND ALSO reserving to us our heirs and successors free liberty and authority for us our heirs and successors and our and their agents and servants at any time or times hereafter to enter upon the said land and to search and mine therein for gold silver copper tin antimony coal lignite and other metals and minerals and mineral ores and to extract and remove therefrom any gold silver and any auriferous and argentiferous earth or stone copper tin antimony coal lignite and other metals and minerals and mineral ores and to search for and work dispose of and carry away the gold silver copper tin antimony coal lignite metals minerals and their ores and the mines metals and minerals in upon and under the land hereby granted and for the purposes aforesaid to sink shafts erect machinery carry on any works and do any other things which may be necessary or usual in mining PROVIDED ALWAYS that it shall be lawful for us our heirs and successors at any time on paying full compensation to the said GRANTEE</p> <p>his heirs executors administrators or assigns for the full value other than that due to any metals or minerals or mineral ores being thereon or thereunder of the said piece of land or so much thereof as may be resumed as hereinafter mentioned and of the improvements upon the said piece of land or the part so resumed such value in case of disagreement to be ascertained by arbitration to resume the said piece of land or any part thereof for mining purposes AND THAT the terms conditions and events upon which such land may be resumed and the manner in which such arbitration may be conducted may be determined by regulations in such manner as the Governor in Council may from time to time direct or if at any time no such regulations shall be in force then by the regulations concerning the resumption of land for mining purposes in force at the date of this Grant unless Parliament shall otherwise determine.</p>			
LENGTHS ARE IN LINKS		Metres = 0.3946 x Feet Metres = 0.201168 x Links	Sheet 2 of 2 sheets

Copyright State of Victoria. No part of this publication may be reproduced except as permitted by the Copyright Act 1968 (Cth), to comply with a statutory requirement or pursuant to a written agreement. The information is only valid at the time and in the form obtained from the LANDATA REGD TM System. None of the State of Victoria, its agents or contractors, accepts responsibility for any subsequent publication or reproduction of the information.

The Victorian Government acknowledges the Traditional Owners of Victoria and pays respects to their ongoing connection to their Country, History and Culture. The Victorian Government extends this respect to their Elders, past, present and emerging.

REGISTER SEARCH STATEMENT (Title Search) Transfer of Land Act 1958

VOLUME 11611 FOLIO 969

Security no : 124127391524F
Produced 22/08/2025 11:21 AM

LAND DESCRIPTION

Crown Allotment 5 Section D Parish of Barkly.
PARENT TITLE Volume 09759 Folio 324
Created by instrument AM323390G 13/11/2015

REGISTERED PROPRIETOR

Estate Fee Simple
Sole Proprietor
BRADLEY RUPERT BIBBY of 1006 BARKLY ROAD NAVARRE VIC 3384
AN258661D 09/11/2016

ENCUMBRANCES, CAVEATS AND NOTICES

MORTGAGE AN258662B 09/11/2016
AUSTRALIA AND NEW ZEALAND BANKING GROUP LTD

For details of any other encumbrances see the plan or imaged folio set out under DIAGRAM LOCATION below.

DIAGRAM LOCATION

SEE TP301942E FOR FURTHER DETAILS AND BOUNDARIES

ACTIVITY IN THE LAST 125 DAYS

NIL

-----END OF REGISTER SEARCH STATEMENT-----

Additional information: (not part of the Register Search Statement)

Street Address: STAWELL-AVOCA ROAD BARKLY VIC 3384

ADMINISTRATIVE NOTICES

NIL

eCT Control 15314Q ANZ RETAIL BANKING
Effective from 09/11/2016

DOCUMENT END

Delivered from the LANDATA® System by InfoTrack Pty Ltd.

The information supplied by InfoTrack (LEAP) has been obtained from InfoTrack Pty Limited by agreement between them. The information supplied has been obtained by InfoTrack Pty Limited who is licensed by the State of Victoria to provide this information via LANDATA® System.

© State of Victoria. This publication is copyright. No part may be reproduced by any process except in accordance with the provisions of the Copyright Act 1968 (Cth) and for the purposes of Section 32 of the Sale of Land Act 1962 or pursuant to a written agreement. The information is only valid at the time and in the form obtained from the LANDATA® System. None of the State of Victoria, LANDATA®, Secure Electronic Registries Victoria Pty Ltd (ABN 86 627 986 396) as trustee for the Secure Electronic Registries Victoria Trust (ABN 83 206 746 897) accept responsibility for any subsequent release, publication or reproduction of the information.

TITLE PLAN		EDITION 1	TP 301942E
Location of Land Parish: BARKLY Township: Section: D Crown Allotment: 3 A, 5, 5 A, 6, 6 A, 7, 7 A, 8 A, 10 Crown Portion: Last Plan Reference: Derived From: VOL 9759 FOL 324 Depth Limitation: NIL		Notations WATERWAY NOTATION: C.A.'s 10, 7A, 6A, 6 & 3A IN THIS PLAN MAY ABUT CROWN LAND THAT MAY BE SUBJECT TO A CROWN LICENCE TO USE ANY REFERENCE TO MAP IN THE TEXT MEANS THE DIAGRAM SHOWN ON THIS TITLE PLAN	
Description of Land / Easement Information			THIS PLAN HAS BEEN PREPARED FOR THE LAND REGISTRY, LAND VICTORIA, FOR TITLE DIAGRAM PURPOSES AS PART OF THE LAND TITLES AUTOMATION PROJECT COMPILED: 02/02/2000 VERIFIED: AA
<p style="text-align: right;">TOTAL AREA 33.22 ha</p>			
LENGTHS ARE IN METRES		Metres = 0.3048 x Feet Metres = 0.201168 x Links	Sheet 1 of 1 sheets

PROPERTY REPORT



Energy,
Environment
and Climate Action

From www.land.vic.gov.au at 12 August 2025 03:29 PM

PROPERTY DETAILS

Crown Description: **Allot. 46 Sec. D PARISH OF BARKLY**
Address: **STAWELL-AVOCA ROAD BARKLY 3384**
Standard Parcel Identifier (SPI): **46-D\PP2074**
Local Government Area (Council): **PYRENEES**
Council Property Number: **101037700 (Part)**
Directory Reference: **Vicroads 42 D9**

www.pyrenees.vic.gov.au

SITE DIMENSIONS

All dimensions and areas are approximate. They may not agree with those shown on a title or plan.

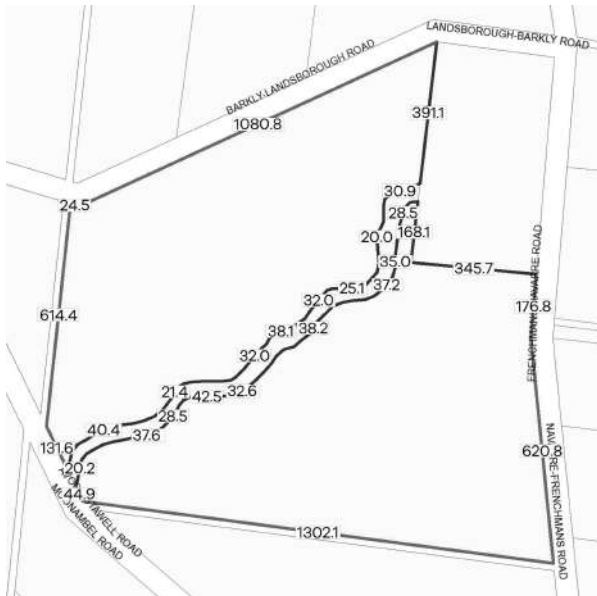

Area: 1264813 sq. m (126.48 ha)

Perimeter: 7653 m

For this property:

- Site boundaries
- Road frontages

Dimensions for individual parcels require a separate search, but dimensions for individual units are generally not available.

84 overlapping dimension labels are not being displayed

Calculating the area from the dimensions shown may give a different value to the area shown above

For more accurate dimensions get copy of plan at [Title and Property Certificates](#)

PARCEL DETAILS

This is 1 parcel of 3 parcels comprising this property. The parcel searched for is marked with an * in the table below

Lot/Plan or Crown Description	SPI
PARISH OF BARKLY	
Allot. 5 Sec. D	5-D\PP2074
Allot. 45 Sec. D	45-D\PP2074
* Allot. 46 Sec. D	46-D\PP2074

UTILITIES

Rural Water Corporation: **Grampians Wimmera Mallee Water**
Urban Water Corporation: **Central Highlands Water**
Melbourne Water: **Outside drainage boundary**
Power Distributor: **POWERCOR**

STATE ELECTORATES

Legislative Council: **WESTERN VICTORIA**
Legislative Assembly: **RIPON**

Copyright © - State Government of Victoria

Disclaimer: This content is provided for information purposes only. No claim is made as to the accuracy or authenticity of the content. The Victorian Government does not accept any liability to any person for the information provided.
Read the full disclaimer at <https://www.deeca.vic.gov.au/disclaimer>

PROPERTY REPORT: Allot. 46 Sec. D PARISH OF BARKLY

Page 1 of 2

Energy,
Environment
and Climate Action

Property and parcel search <https://www.land.vic.gov.au/property-and-parcel-search>

The map displays the study area with the selected parcel highlighted in grey. Key roads shown include Stawell-Avoca Road, Frenchman Track, Frenchman's Navarre Road, and Frenchman's Saint Arnaud Road. Water courses are indicated by blue lines. A scale bar at the bottom right shows a distance of 1500 m.

From www.planning.vic.gov.au at 12 August 2025 03:28 PM

PROPERTY DETAILS

Crown Description: **Allot. 46 Sec. D PARISH OF BARKLY**
 Address: **STAWELL-AVOCA ROAD BARKLY 3384**
 Standard Parcel Identifier (SPI): **46-D\PP2074**
 Local Government Area (Council): **PYRENEES**
 Council Property Number: **101037700 (Part)**
 Planning Scheme: **Pyrenees**
 Directory Reference: **Vicroads 42 D9**

www.pyrenees.vic.gov.au

[Planning Scheme - Pyrenees](#)

This parcel is one of 3 parcels comprising the property. For full parcel details get the free Property report at [Property Reports](#)

UTILITIES

Rural Water Corporation: **Grampians Wimmera Mallee Water**
 Urban Water Corporation: **Central Highlands Water**
 Melbourne Water: **Outside drainage boundary**
 Power Distributor: **POWERCOR**

STATE ELECTORATES

Legislative Council: **WESTERN VICTORIA**
 Legislative Assembly: **RIPON**
 Registered Aboriginal Party: **None**
 Fire Authority: **Country Fire Authority**

[View location in VicPlan](#)

Planning Zones

[FARMING ZONE \(FZ\)](#)

[SCHEDULE TO THE FARMING ZONE \(FZ\)](#)

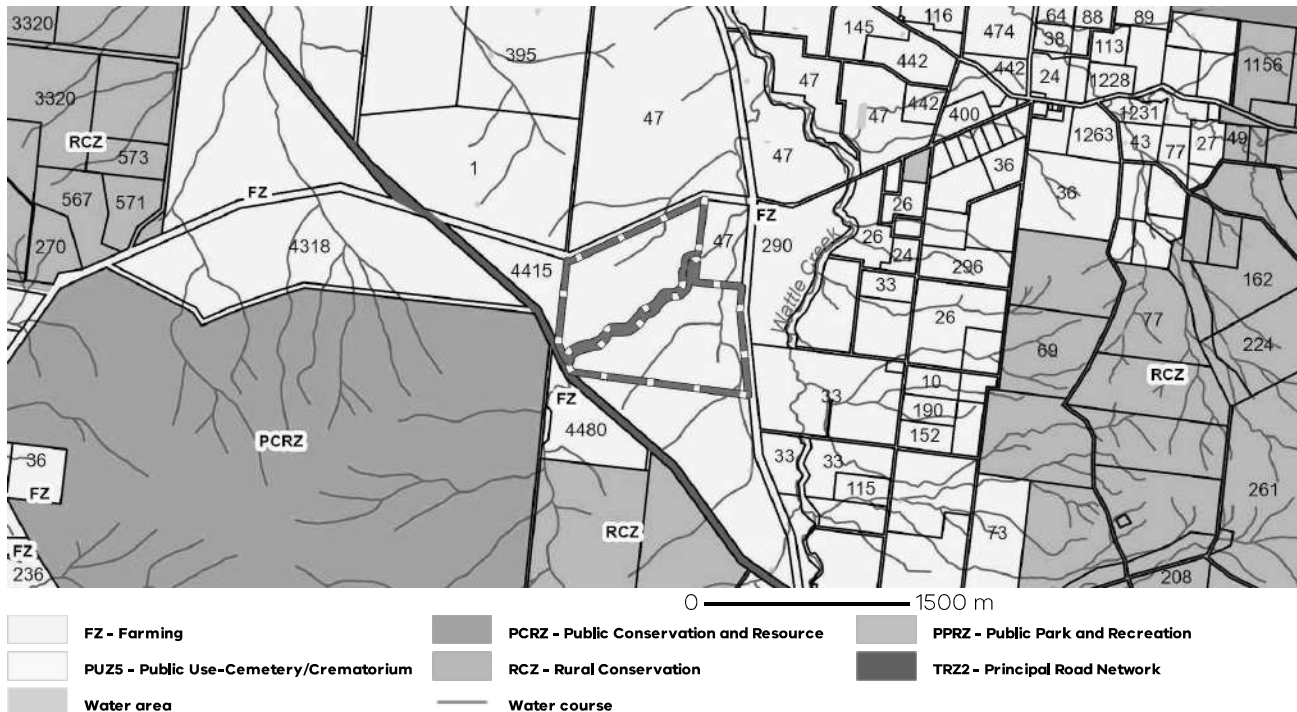

Note: labels for zones may appear outside the actual zone - please compare the labels with the legend.

Copyright © - State Government of Victoria

Disclaimer: This content is provided for information purposes only. No claim is made as to the accuracy or authenticity of the content. The Victorian Government does not accept any liability to any person for the information provided.
 Read the full disclaimer at <https://www.vic.gov.au/disclaimer>

Notwithstanding this disclaimer, a vendor may rely on the information in this report for the purpose of a statement that land is in a bushfire prone area as required by section 32C (b) of the Sale of Land 1962 (Vic).

Planning Overlays

BUSHFIRE MANAGEMENT OVERLAY (BMO)

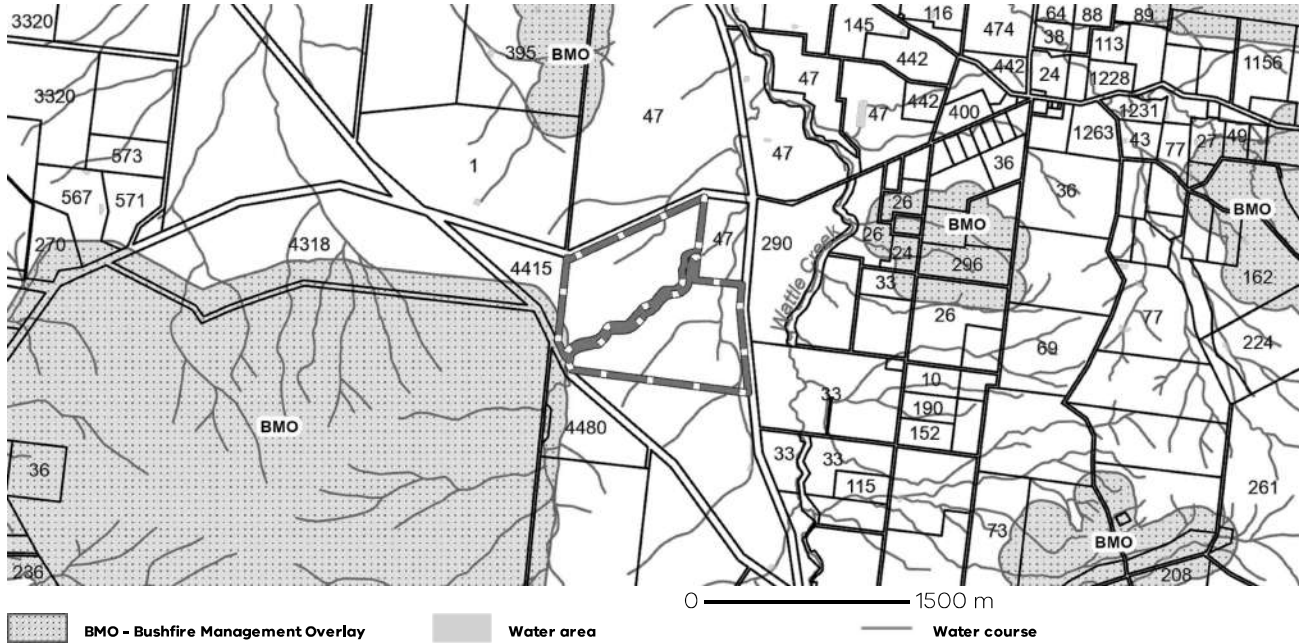

DESIGN AND DEVELOPMENT OVERLAY (DDO)

DESIGN AND DEVELOPMENT OVERLAY - SCHEDULE 1 (DDO1)

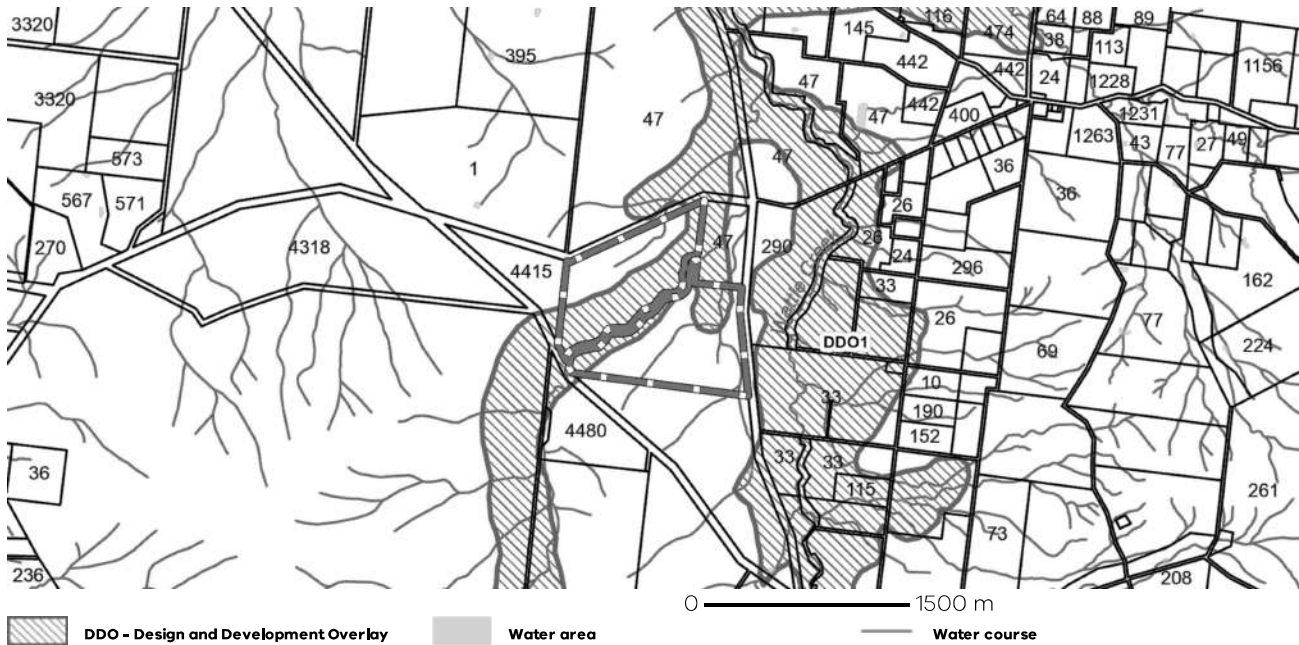

Planning Overlays

OTHER OVERLAYS

Other overlays in the vicinity not directly affecting this land

RESTRUCTURE OVERLAY (RO)



Further Planning Information

Planning scheme data last updated on 8 August 2025.

A **planning scheme** sets out policies and requirements for the use, development and protection of land.

This report provides information about the zone and overlay provisions that apply to the selected land.

Information about the State and local policy, particular, general and operational provisions of the local planning scheme that may affect the use of this land can be obtained by contacting the local council or by visiting <https://www.planning.vic.gov.au>

This report is NOT a **Planning Certificate** issued pursuant to Section 199 of the **Planning and Environment Act 1987**.

It does not include information about exhibited planning scheme amendments, or zonings that may affect the land.

To obtain a Planning Certificate go to Titles and Property Certificates at Landata - <https://www.landata.vic.gov.au>

For details of surrounding properties, use this service to get the Reports for properties of interest.

To view planning zones, overlay and heritage information in an interactive format visit

<https://mapshare.maps.vic.gov.au/vicplan>

For other information about planning in Victoria visit <https://www.planning.vic.gov.au>

Designated Bushfire Prone Areas

This parcel is in a designated bushfire prone area. Special bushfire construction requirements apply to the part of the property mapped as a designated bushfire prone area (BPA). Planning provisions may apply.

Where part of the property is mapped as BPA, if no part of the building envelope or footprint falls within the BPA area, the BPA construction requirements do not apply.

Note: the relevant building surveyor determines the need for compliance with the bushfire construction requirements.



Designated BPA are determined by the Minister for Planning following a detailed review process. The Building Regulations 2018, through adoption of the Building Code of Australia, apply bushfire protection standards for building works in designated BPA.

Designated BPA maps can be viewed on VicPlan at <https://mapshare.vic.gov.au/vicplan/> or at the relevant local council.

Create a BPA definition plan in [VicPlan](#) to measure the BPA.

Information for lot owners building in the BPA is available at <https://www.planning.vic.gov.au>.

Further information about the building control system and building in bushfire prone areas can be found on the Victorian Building Authority website <https://www.vba.vic.gov.au>. Copies of the Building Act and Building Regulations are available from <http://www.legislation.vic.gov.au>. For Planning Scheme Provisions in bushfire areas visit <https://www.planning.vic.gov.au>.

Native Vegetation

Native plants that are indigenous to the region and important for biodiversity might be present on this property. This could include trees, shrubs, herbs, grasses or aquatic plants. There are a range of regulations that may apply including need to obtain a planning permit under Clause 52.17 of the local planning scheme. For more information see [Native Vegetation \(Clause 52.17\)](#) with local variations in [Native Vegetation \(Clause 52.17\) Schedule](#)

To help identify native vegetation on this property and the application of Clause 52.17 please visit the Native Vegetation Information Management system <https://nvim.delwp.vic.gov.au/> and [Native vegetation \(environment.vic.gov.au\)](#) or please contact your relevant council.

You can find out more about the natural values on your property through NatureKit [NatureKit \(environment.vic.gov.au\)](#)

PROPERTY REPORT

From www.land.vic.gov.au at 12 August 2025 03:30 PM

PROPERTY DETAILS

Crown Description: **Allot. 45 Sec. D PARISH OF BARKLY**
Address: **STAWELL-AVOCA ROAD BARKLY 3384**
Standard Parcel Identifier (SPI): **45-D\PP2074**
Local Government Area (Council): **PYRENEES**
Council Property Number: **101037700 (Part)**
Directory Reference: **Vicroads 42 D9**

www.pyrenees.vic.gov.au

SITE DIMENSIONS

All dimensions and areas are approximate. They may not agree with those shown on a title or plan.

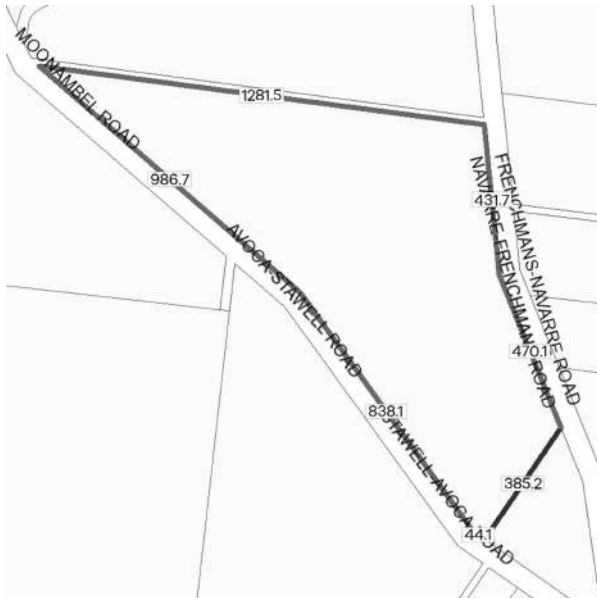

Area: 766398 sq. m (76.64 ha)

Perimeter: 4437 m

For this property:

- Site boundaries
- Road frontages

Dimensions for individual parcels require a separate search, but dimensions for individual units are generally not available.

Calculating the area from the dimensions shown may give a different value to the area shown above

For more accurate dimensions get copy of plan at [Title and Property Certificates](#)

PARCEL DETAILS

This is 1 parcel of 3 parcels comprising this property. The parcel searched for is marked with an * in the table below

Lot/Plan or Crown Description	SPI
PARISH OF BARKLY	
Allot. 5 Sec. D	5-D\PP2074
* Allot. 45 Sec. D	45-D\PP2074
Allot. 46 Sec. D	46-D\PP2074

UTILITIES

Rural Water Corporation: **Grampians Wimmera Mallee Water**
Urban Water Corporation: **Central Highlands Water**
Melbourne Water: **Outside drainage boundary**
Power Distributor: **POWERCOR**

STATE ELECTORATES

Legislative Council: **WESTERN VICTORIA**
Legislative Assembly: **RIPON**

PROPERTY REPORT

PLANNING INFORMATION

Property Planning details have been removed from the Property Reports to avoid duplication with the Planning Property Reports from the Department of Transport and Planning which are the authoritative source for all Property Planning information.

The Planning Property Report for this parcel can found here - [Planning Property Report](#)

Planning Property Reports can be found via these two links

Vicplan <https://mapshare.vic.gov.au/vicplan/>

Property and parcel search <https://www.land.vic.gov.au/property-and-parcel-search>

Area Map

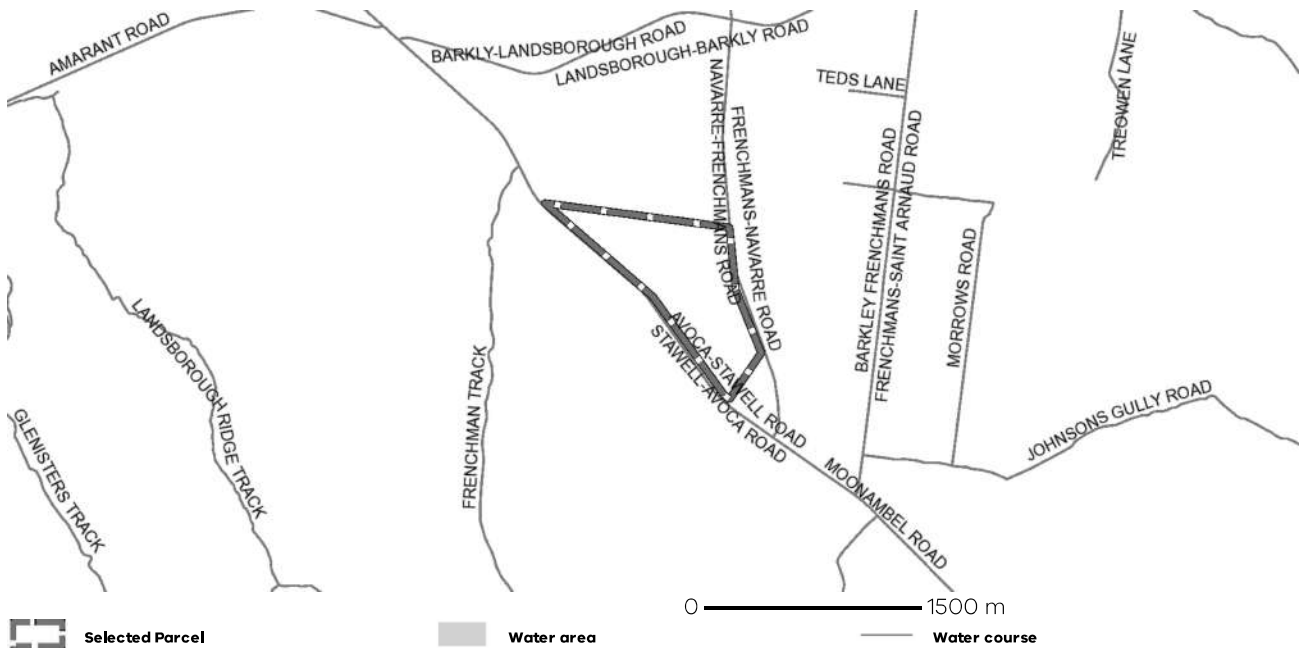

From www.planning.vic.gov.au at 12 August 2025 03:30 PM

PROPERTY DETAILS

Crown Description: **Allot. 45 Sec. D PARISH OF BARKLY**
Address: **STAWELL-AVOCA ROAD BARKLY 3384**
Standard Parcel Identifier (SPI): **45-D\PP2074**
Local Government Area (Council): **PYRENEES**
Council Property Number: **101037700 (Part)**
Planning Scheme: **Pyrenees**
Directory Reference: **Vicroads 42 D9**

www.pyrenees.vic.gov.au

[Planning Scheme - Pyrenees](#)

This parcel is one of 3 parcels comprising the property. For full parcel details get the free Property report at [Property Reports](#)

UTILITIES

Rural Water Corporation: **Grampians Wimmera Mallee Water**
Urban Water Corporation: **Central Highlands Water**
Melbourne Water: **Outside drainage boundary**
Power Distributor: **POWERCOR**

STATE ELECTORATES

Legislative Council: **WESTERN VICTORIA**
Legislative Assembly: **RIPON**
Registered Aboriginal Party: **None**
Fire Authority: **Country Fire Authority**

[View location in VicPlan](#)

Planning Zones

[FARMING ZONE \(FZ\)](#)

[SCHEDULE TO THE FARMING ZONE \(FZ\)](#)

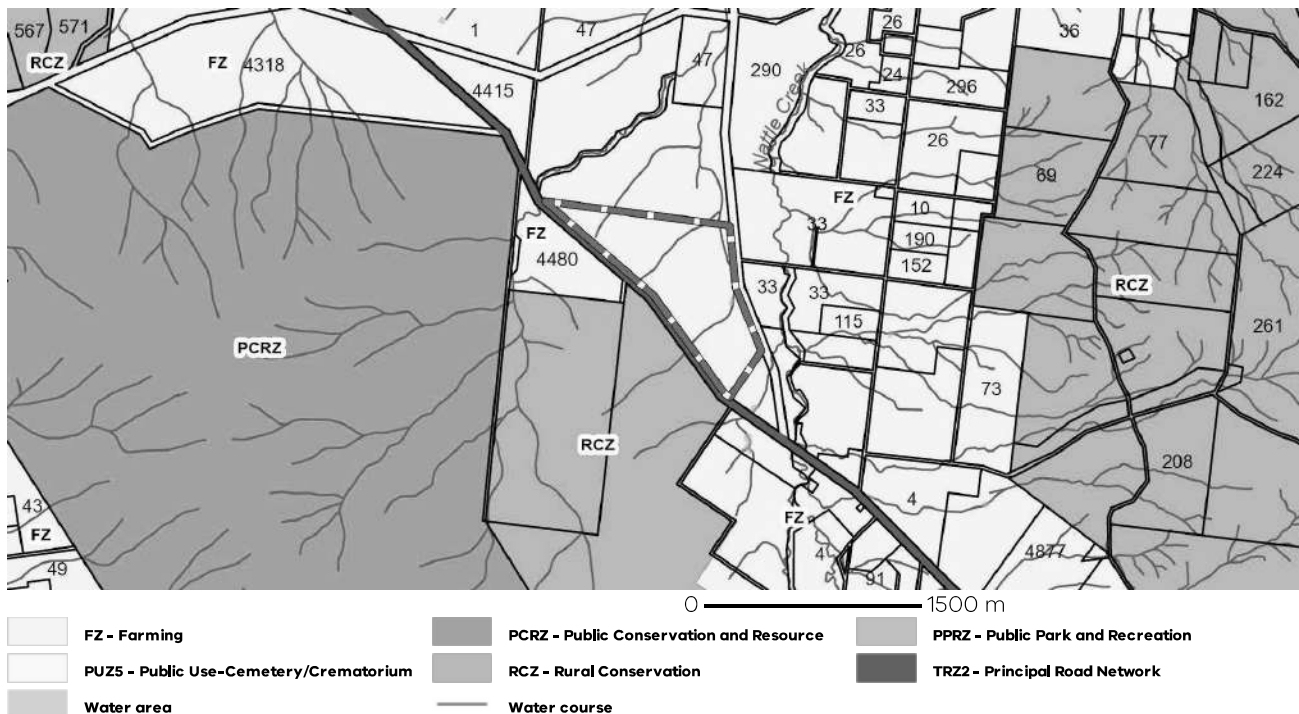

Note: labels for zones may appear outside the actual zone - please compare the labels with the legend.

Copyright © - State Government of Victoria

Disclaimer: This content is provided for information purposes only. No claim is made as to the accuracy or authenticity of the content. The Victorian Government does not accept any liability to any person for the information provided. Read the full disclaimer at <https://www.vic.gov.au/disclaimer>

Notwithstanding this disclaimer, a vendor may rely on the information in this report for the purpose of a statement that land is in a bushfire prone area as required by section 32C (b) of the Sale of Land 1962 (Vic).

Planning Overlays

DESIGN AND DEVELOPMENT OVERLAY (DDO)

DESIGN AND DEVELOPMENT OVERLAY - SCHEDULE 1 (DDO1)

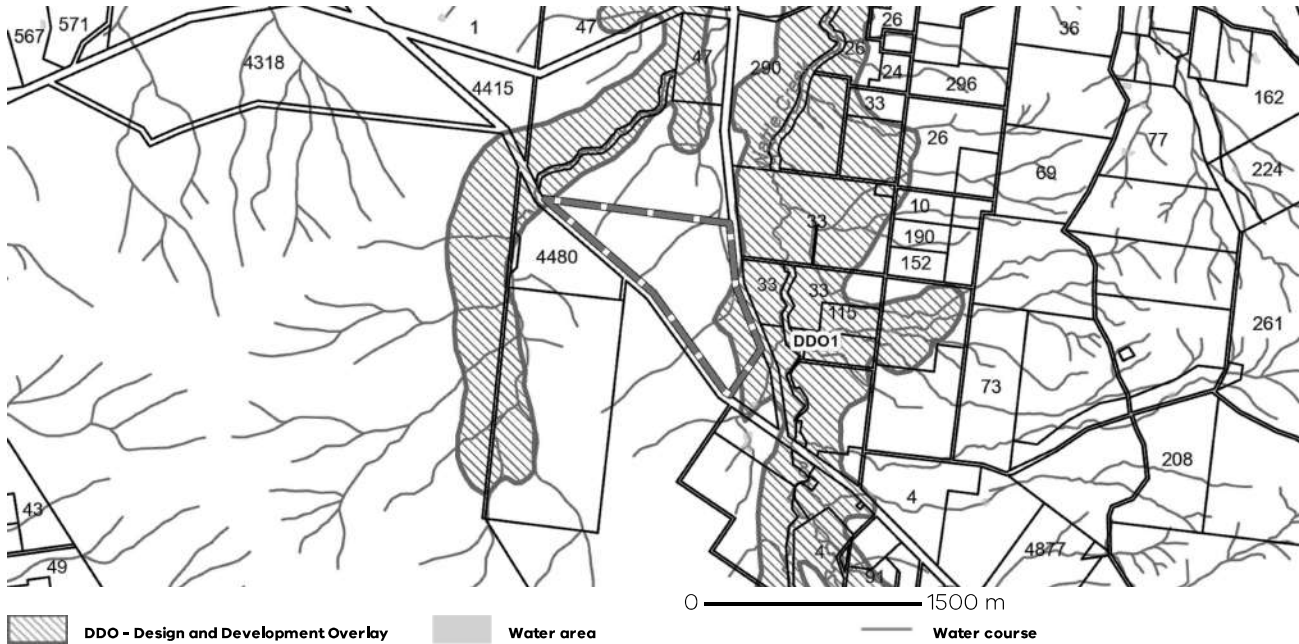

Note: due to overlaps, some overlays may not be visible, and some colours may not match those in the legend

OTHER OVERLAYS

Other overlays in the vicinity not directly affecting this land

BUSHFIRE MANAGEMENT OVERLAY (BMO)

RESTRUCTURE OVERLAY (RO)

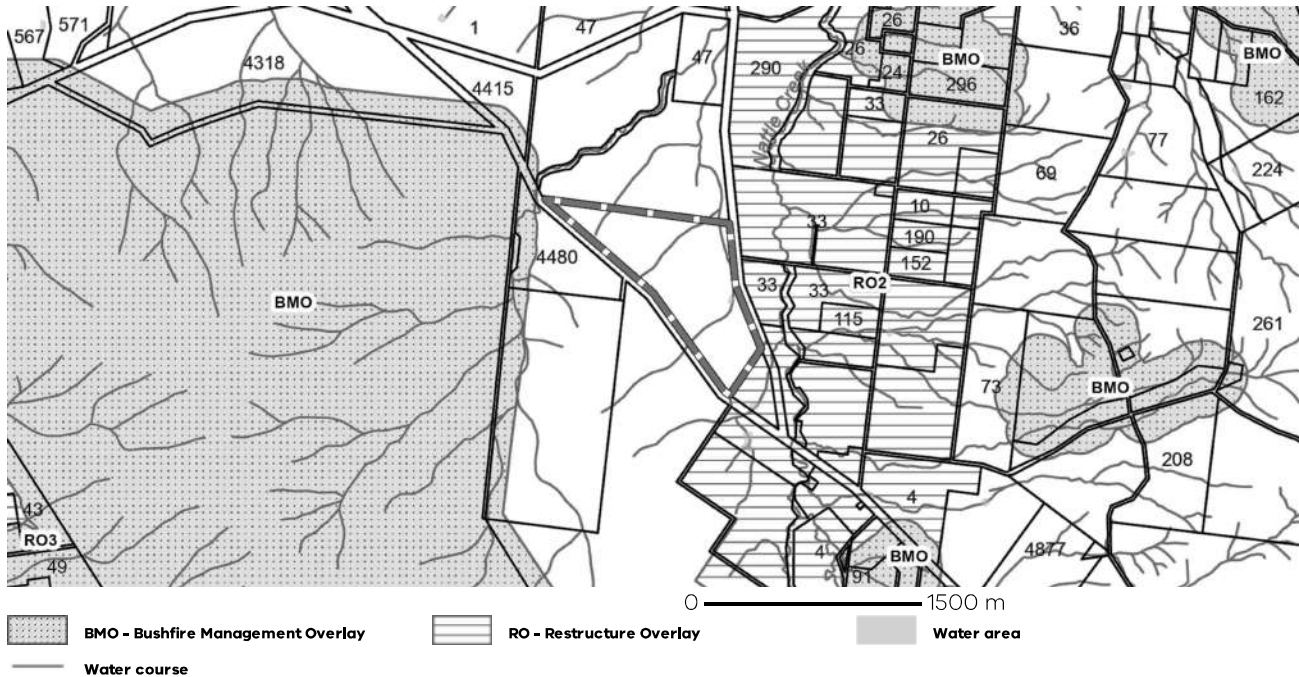

Note: due to overlaps, some overlays may not be visible, and some colours may not match those in the legend

Copyright © - State Government of Victoria

Disclaimer: This content is provided for information purposes only. No claim is made as to the accuracy or authenticity of the content. The Victorian Government does not accept any liability to any person for the information provided.

Read the full disclaimer at <https://www.vic.gov.au/disclaimer>

Notwithstanding this disclaimer, a vendor may rely on the information in this report for the purpose of a statement that land is in a bushfire prone area as required by section 32C (b) of the Sale of Land 1962 (Vic).

Areas of Aboriginal Cultural Heritage Sensitivity

All or part of this parcel is an 'area of cultural heritage sensitivity'.

'Areas of cultural heritage sensitivity' are defined under the Aboriginal Heritage Regulations 2018, and include registered Aboriginal cultural heritage places and land form types that are generally regarded as more likely to contain Aboriginal cultural heritage.

Under the Aboriginal Heritage Regulations 2018, 'areas of cultural heritage sensitivity' are one part of a two part trigger which require a 'cultural heritage management plan' be prepared where a listed 'high impact activity' is proposed.

If a significant land use change is proposed (for example, a subdivision into 3 or more lots), a cultural heritage management plan may be triggered. One or two dwellings, works ancillary to a dwelling, services to a dwelling, alteration of buildings and minor works are examples of works exempt from this requirement.

Under the Aboriginal Heritage Act 2006, where a cultural heritage management plan is required, planning permits, licences and work authorities cannot be issued unless the cultural heritage management plan has been approved for the activity.

For further information about whether a Cultural Heritage Management Plan is required go to <https://heritage.achris.vic.gov.au/aavQuestion1.aspx>

More information, including links to both the Aboriginal Heritage Act 2006 and the Aboriginal Heritage Regulations 2018, can also be found here - <https://www.firstpeoplesrelations.vic.gov.au/aboriginal-heritage-legislation>

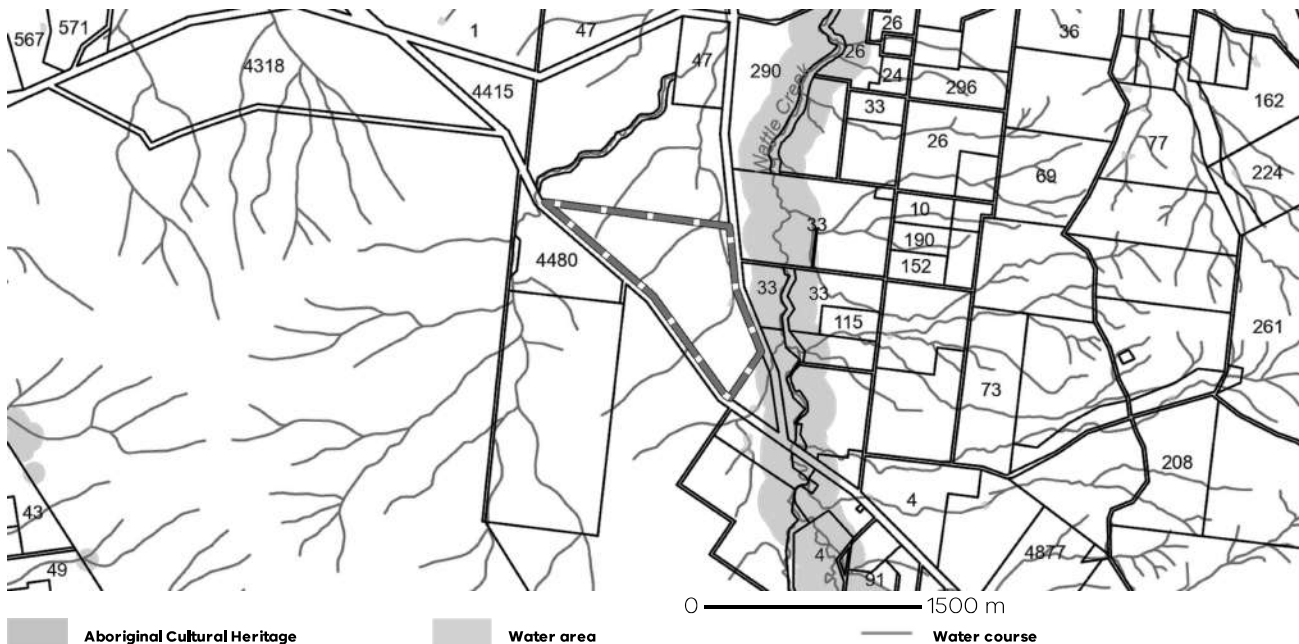

Further Planning Information

Planning scheme data last updated on 8 August 2025.

A **planning scheme** sets out policies and requirements for the use, development and protection of land.

This report provides information about the zone and overlay provisions that apply to the selected land.

Information about the State and local policy, particular, general and operational provisions of the local planning scheme that may affect the use of this land can be obtained by contacting the local council

or by visiting <https://www.planning.vic.gov.au>

This report is NOT a **Planning Certificate** issued pursuant to Section 199 of the **Planning and Environment Act 1987**.

It does not include information about exhibited planning scheme amendments, or zonings that may affect the land.

To obtain a Planning Certificate go to Titles and Property Certificates at Landata - <https://www.landata.vic.gov.au>

For details of surrounding properties, use this service to get the Reports for properties of interest.

To view planning zones, overlay and heritage information in an interactive format visit

<https://mapshare.maps.vic.gov.au/vicplan>

For other information about planning in Victoria visit <https://www.planning.vic.gov.au>

Designated Bushfire Prone Areas

This parcel is in a designated bushfire prone area. Special bushfire construction requirements apply to the part of the property mapped as a designated bushfire prone area (BPA). Planning provisions may apply.

Where part of the property is mapped as BPA, if no part of the building envelope or footprint falls within the BPA area, the BPA construction requirements do not apply.

Note: the relevant building surveyor determines the need for compliance with the bushfire construction requirements.

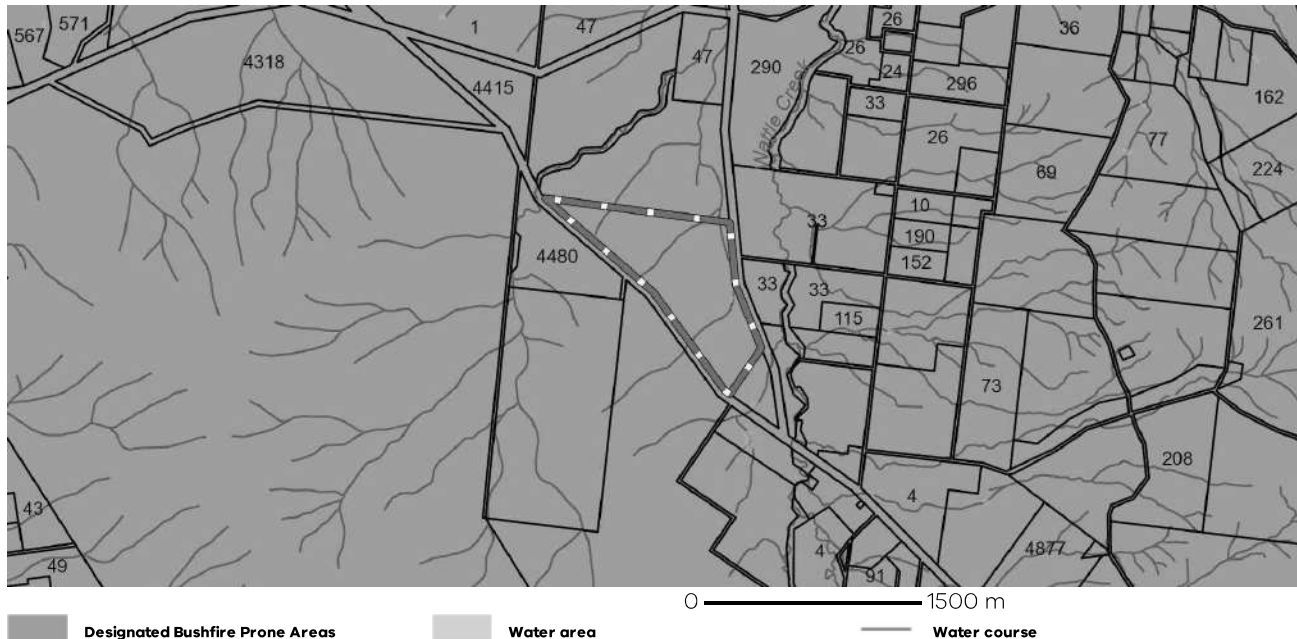

Designated BPA are determined by the Minister for Planning following a detailed review process. The Building Regulations 2018, through adoption of the Building Code of Australia, apply bushfire protection standards for building works in designated BPA.

Designated BPA maps can be viewed on VicPlan at <https://mapshare.vic.gov.au/vicplan/> or at the relevant local council.

Create a BPA definition plan in [VicPlan](#) to measure the BPA.

Information for lot owners building in the BPA is available at <https://www.planning.vic.gov.au>.

Further information about the building control system and building in bushfire prone areas can be found on the Victorian Building Authority website <https://www.vba.vic.gov.au>. Copies of the Building Act and Building Regulations are available from <http://www.legislation.vic.gov.au>. For Planning Scheme Provisions in bushfire areas visit <https://www.planning.vic.gov.au>.

Native Vegetation

Native plants that are indigenous to the region and important for biodiversity might be present on this property. This could include trees, shrubs, herbs, grasses or aquatic plants. There are a range of regulations that may apply including need to obtain a planning permit under Clause 52.17 of the local planning scheme. For more information see [Native Vegetation \(Clause 52.17\)](#) with local variations in [Native Vegetation \(Clause 52.17\) Schedule](#)

To help identify native vegetation on this property and the application of Clause 52.17 please visit the Native Vegetation Information Management system <https://nvim.delwp.vic.gov.au/> and [Native vegetation \(environment.vic.gov.au\)](#) or please contact your relevant council.

You can find out more about the natural values on your property through NatureKit [NatureKit \(environment.vic.gov.au\)](#)

PROPERTY REPORT

From www.land.vic.gov.au at 12 August 2025 03:32 PM

PROPERTY DETAILS

Crown Description: **Allot. 5 Sec. D PARISH OF BARKLY**
Address: **STAWELL-AVOCA ROAD BARKLY 3384**
Standard Parcel Identifier (SPI): **5-D\PP2074**
Local Government Area (Council): **PYRENEES**
Council Property Number: **101037700 (Part)**
Directory Reference: **Vicroads 42 D9**

www.pyrenees.vic.gov.au

SITE DIMENSIONS

All dimensions and areas are approximate. They may not agree with those shown on a title or plan.

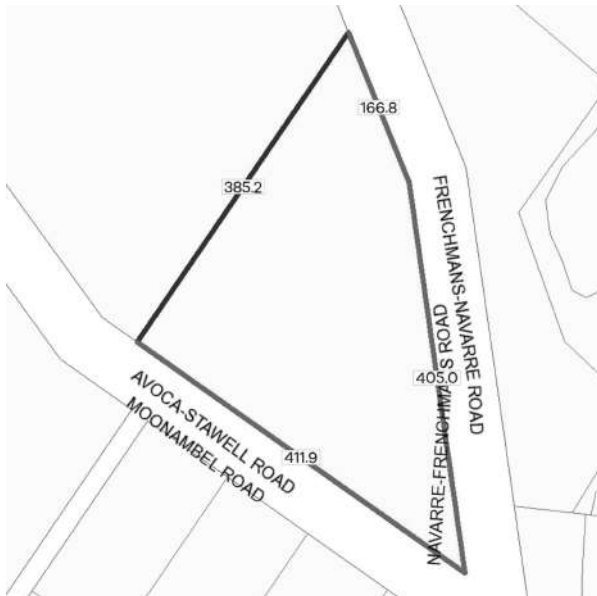

Area: 87408 sq. m (8.74 ha)

Perimeter: 1369 m

For this property:

- Site boundaries
- Road frontages

Dimensions for individual parcels require a separate search, but dimensions for individual units are generally not available.

Calculating the area from the dimensions shown may give a different value to the area shown above

For more accurate dimensions get copy of plan at [Title and Property Certificates](#)

PARCEL DETAILS

This is 1 parcel of 3 parcels comprising this property. The parcel searched for is marked with an * in the table below

Lot/Plan or Crown Description	SPI
PARISH OF BARKLY	
* Allot. 5 Sec. D	5-D\PP2074
Allot. 45 Sec. D	45-D\PP2074
Allot. 46 Sec. D	46-D\PP2074

UTILITIES

Rural Water Corporation: **Grampians Wimmera Mallee Water**
Urban Water Corporation: **Central Highlands Water**
Melbourne Water: **Outside drainage boundary**
Power Distributor: **POWERCOR**

STATE ELECTORATES

Legislative Council: **WESTERN VICTORIA**
Legislative Assembly: **RIPON**

PROPERTY REPORT



Energy,
Environment
and Climate Action

PLANNING INFORMATION

Property Planning details have been removed from the Property Reports to avoid duplication with the Planning Property Reports from the Department of Transport and Planning which are the authoritative source for all Property Planning information.

The Planning Property Report for this parcel can found here - [Planning Property Report](#)

Planning Property Reports can be found via these two links

Vicplan <https://mapshare.vic.gov.au/vicplan/>

Property and parcel search <https://www.land.vic.gov.au/property-and-parcel-search>

Area Map

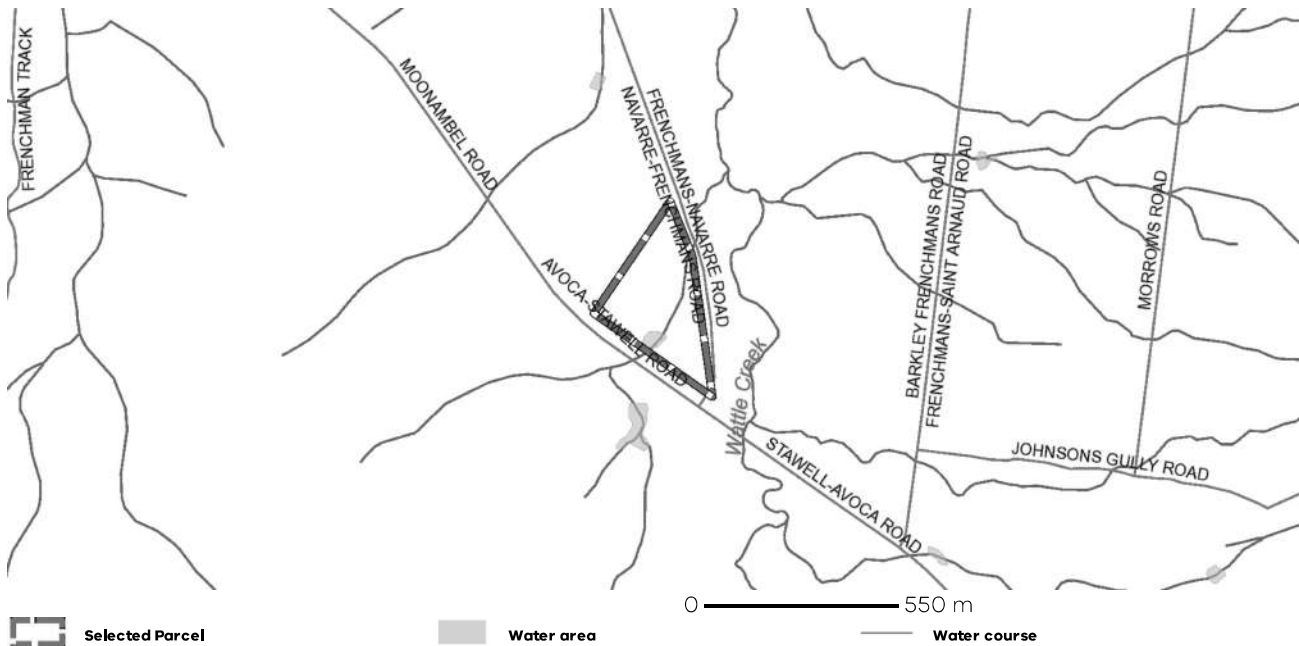

PLANNING PROPERTY REPORT



Department
of Transport
and Planning

From www.planning.vic.gov.au at 12 August 2025 03:32 PM

PROPERTY DETAILS

Crown Description: **Allot. 5 Sec. D PARISH OF BARKLY**
Address: **STAWELL-AVOCA ROAD BARKLY 3384**
Standard Parcel Identifier (SPI): **5-D\PP2074**
Local Government Area (Council): **PYRENEES**
Council Property Number: **101037700 (Part)**
Planning Scheme: **Pyrenees**
Directory Reference: **Vicroads 42 D9**

www.pyrenees.vic.gov.au

[Planning Scheme - Pyrenees](#)

This parcel is one of 3 parcels comprising the property. For full parcel details get the free Property report at [Property Reports](#)

UTILITIES

Rural Water Corporation: **Grampians Wimmera Mallee Water**
Urban Water Corporation: **Central Highlands Water**
Melbourne Water: **Outside drainage boundary**
Power Distributor: **POWERCOR**

STATE ELECTORATES

Legislative Council: **WESTERN VICTORIA**
Legislative Assembly: **RIPON**
Registered Aboriginal Party: **None**
Fire Authority: **Country Fire Authority**

[View location in VicPlan](#)

Planning Zones

[FARMING ZONE \(FZ\)](#)

[SCHEDULE TO THE FARMING ZONE \(FZ\)](#)

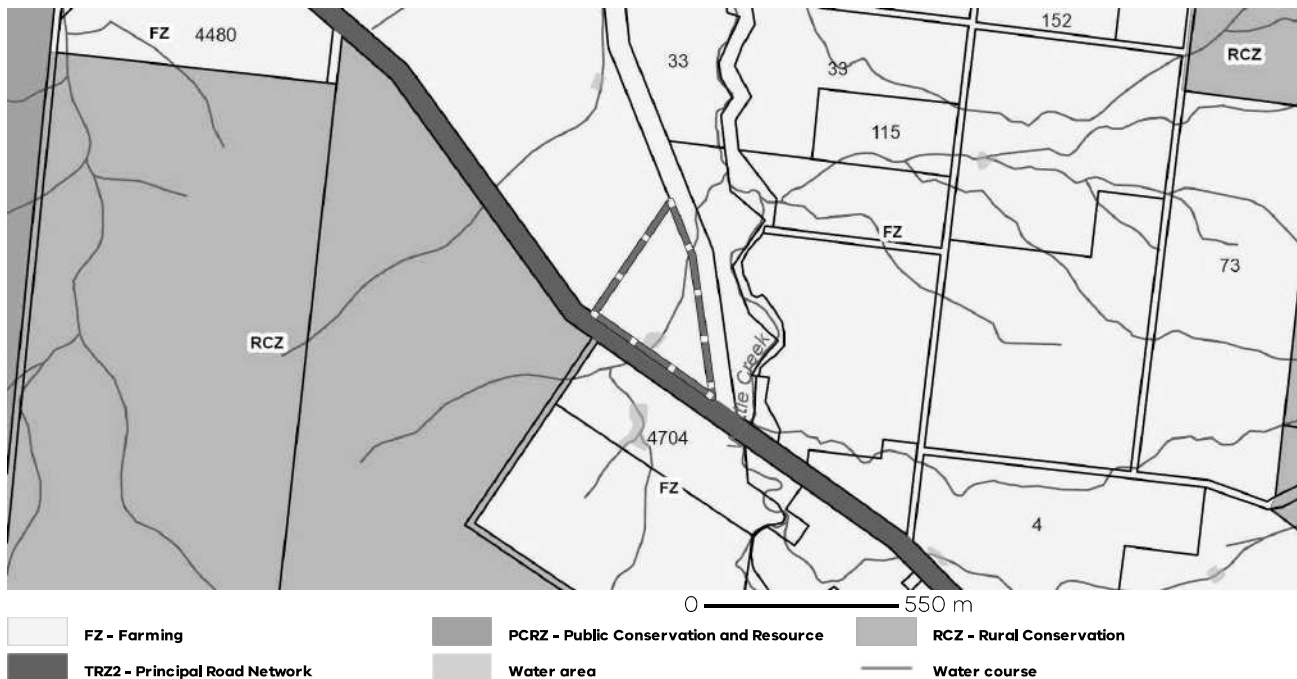

Note: labels for zones may appear outside the actual zone - please compare the labels with the legend.

Copyright © - State Government of Victoria

Disclaimer: This content is provided for information purposes only. No claim is made as to the accuracy or authenticity of the content. The Victorian Government does not accept any liability to any person for the information provided.
Read the full disclaimer at <https://www.vic.gov.au/disclaimer>

Notwithstanding this disclaimer, a vendor may rely on the information in this report for the purpose of a statement that land is in a bushfire prone area as required by section 32C (b) of the Sale of Land 1962 (Vic).

PLANNING PROPERTY REPORT: Allot. 5 Sec. D PARISH OF BARKLY

Page 1 of 6

Planning Overlays

DESIGN AND DEVELOPMENT OVERLAY (DDO)

DESIGN AND DEVELOPMENT OVERLAY - SCHEDULE 1 (DDO1)



Note: due to overlaps, some overlays may not be visible, and some colours may not match those in the legend

RESTRUCTURE OVERLAY (RO)

RESTRUCTURE OVERLAY - SCHEDULE 2 (RO2)



Note: due to overlaps, some overlays may not be visible, and some colours may not match those in the legend

Planning Overlays

OTHER OVERLAYS

Other overlays in the vicinity not directly affecting this land

BUSHFIRE MANAGEMENT OVERLAY (BMO)

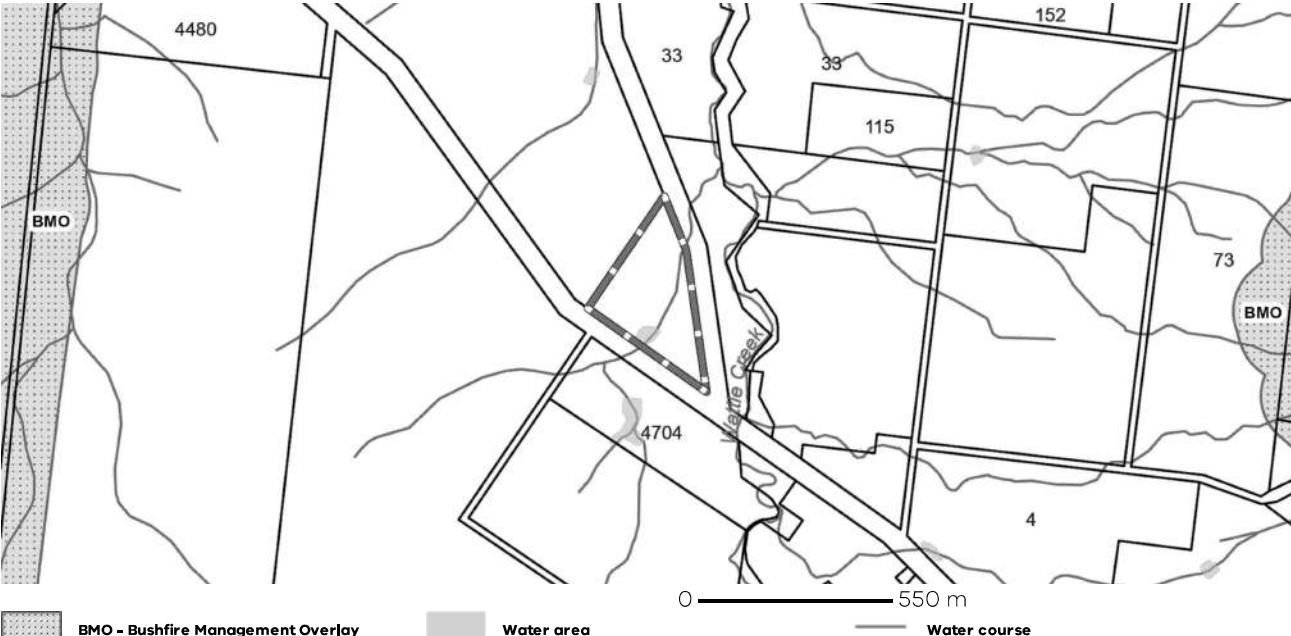

Note: due to overlaps, some overlays may not be visible, and some colours may not match those in the legend

Areas of Aboriginal Cultural Heritage Sensitivity

All or part of this parcel is an 'area of cultural heritage sensitivity'.

'Areas of cultural heritage sensitivity' are defined under the Aboriginal Heritage Regulations 2018, and include registered Aboriginal cultural heritage places and land form types that are generally regarded as more likely to contain Aboriginal cultural heritage.

Under the Aboriginal Heritage Regulations 2018, 'areas of cultural heritage sensitivity' are one part of a two part trigger which require a 'cultural heritage management plan' be prepared where a listed 'high impact activity' is proposed.

If a significant land use change is proposed (for example, a subdivision into 3 or more lots), a cultural heritage management plan may be triggered. One or two dwellings, works ancillary to a dwelling, services to a dwelling, alteration of buildings and minor works are examples of works exempt from this requirement.

Under the Aboriginal Heritage Act 2006, where a cultural heritage management plan is required, planning permits, licences and work authorities cannot be issued unless the cultural heritage management plan has been approved for the activity.

For further information about whether a Cultural Heritage Management Plan is required go to <https://heritage.achris.vic.gov.au/aavQuestion1.aspx>

More information, including links to both the Aboriginal Heritage Act 2006 and the Aboriginal Heritage Regulations 2018, can also be found here - <https://www.firstpeoplesrelations.vic.gov.au/aboriginal-heritage-legislation>

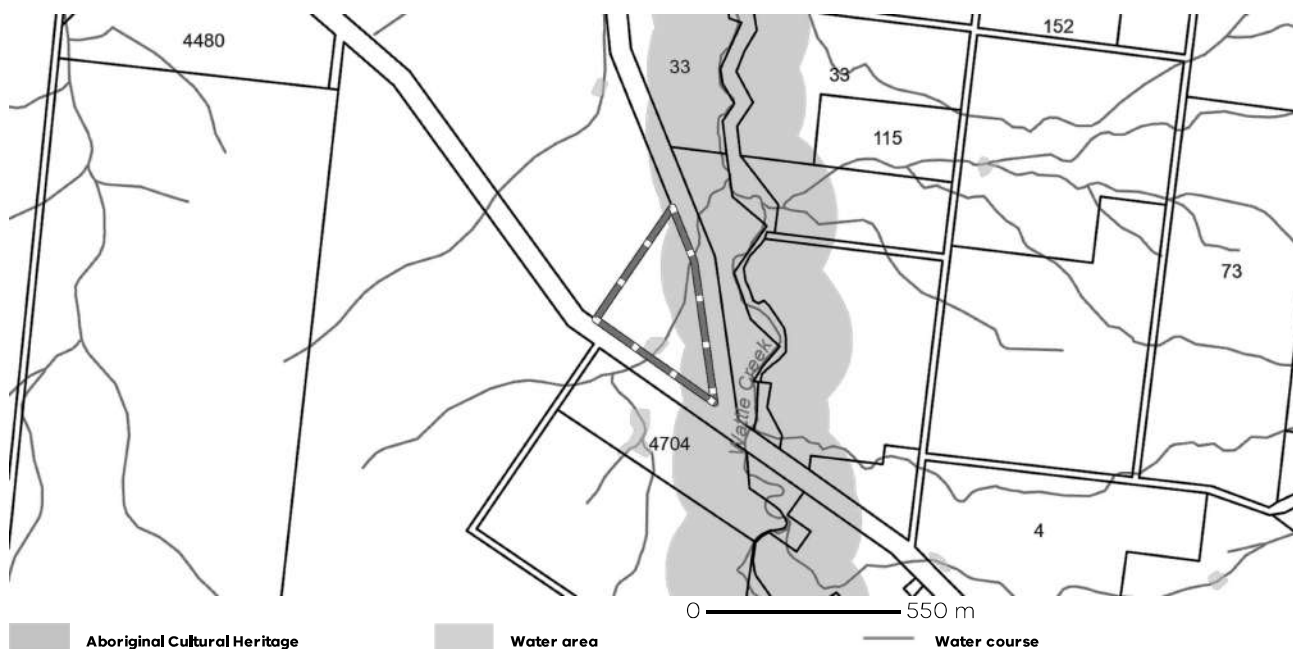

Further Planning Information

Planning scheme data last updated on 8 August 2025.

A **planning scheme** sets out policies and requirements for the use, development and protection of land.

This report provides information about the zone and overlay provisions that apply to the selected land.

Information about the State and local policy, particular, general and operational provisions of the local planning scheme that may affect the use of this land can be obtained by contacting the local council

or by visiting <https://www.planning.vic.gov.au>

This report is NOT a **Planning Certificate** issued pursuant to Section 199 of the **Planning and Environment Act 1987**.

It does not include information about exhibited planning scheme amendments, or zonings that may affect the land.

To obtain a Planning Certificate go to Titles and Property Certificates at Landata - <https://www.landata.vic.gov.au>

For details of surrounding properties, use this service to get the Reports for properties of interest.

To view planning zones, overlay and heritage information in an interactive format visit

<https://mapshare.maps.vic.gov.au/vicplan>

For other information about planning in Victoria visit <https://www.planning.vic.gov.au>

Designated Bushfire Prone Areas

This parcel is in a designated bushfire prone area. Special bushfire construction requirements apply to the part of the property mapped as a designated bushfire prone area (BPA). Planning provisions may apply.

Where part of the property is mapped as BPA, if no part of the building envelope or footprint falls within the BPA area, the BPA construction requirements do not apply.

Note: the relevant building surveyor determines the need for compliance with the bushfire construction requirements.

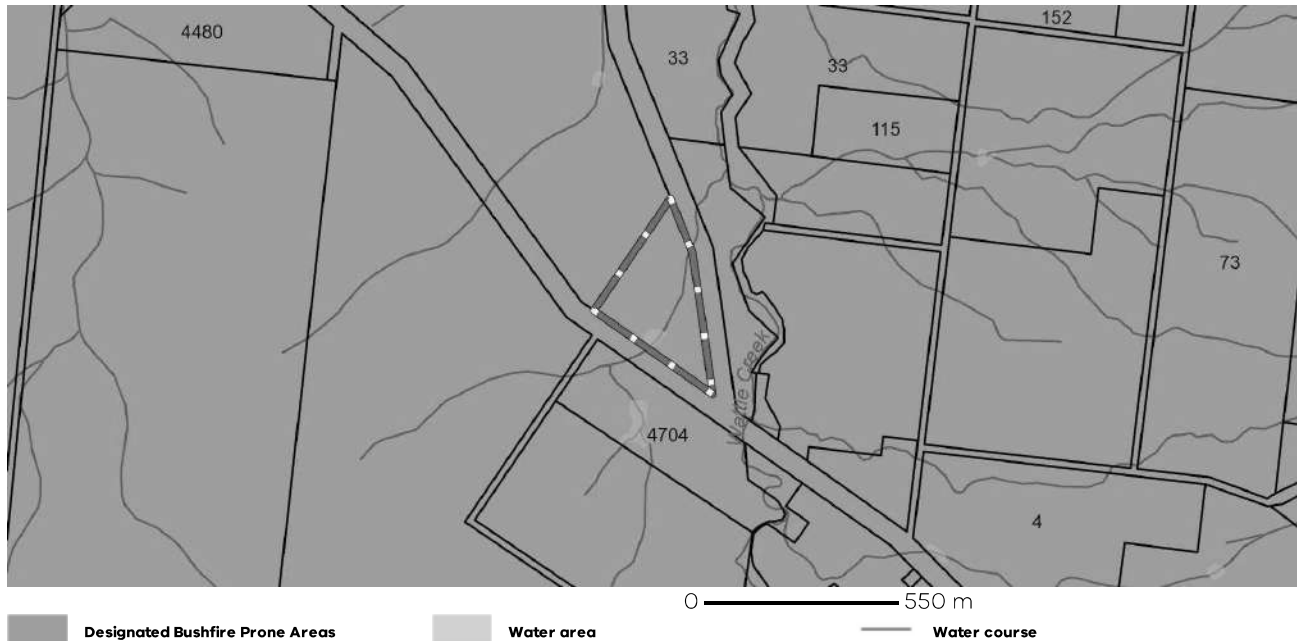

Designated BPA are determined by the Minister for Planning following a detailed review process. The Building Regulations 2018, through adoption of the Building Code of Australia, apply bushfire protection standards for building works in designated BPA.

Designated BPA maps can be viewed on VicPlan at <https://mapshare.vic.gov.au/vicplan/> or at the relevant local council.

Create a BPA definition plan in [VicPlan](#) to measure the BPA.

Information for lot owners building in the BPA is available at <https://www.planning.vic.gov.au>.

Further information about the building control system and building in bushfire prone areas can be found on the Victorian Building Authority website <https://www.vba.vic.gov.au>. Copies of the Building Act and Building Regulations are available from <http://www.legislation.vic.gov.au>. For Planning Scheme Provisions in bushfire areas visit <https://www.planning.vic.gov.au>.

Native Vegetation

Native plants that are indigenous to the region and important for biodiversity might be present on this property. This could include trees, shrubs, herbs, grasses or aquatic plants. There are a range of regulations that may apply including need to obtain a planning permit under Clause 52.17 of the local planning scheme. For more information see [Native Vegetation \(Clause 52.17\)](#) with local variations in [Native Vegetation \(Clause 52.17\) Schedule](#)

To help identify native vegetation on this property and the application of Clause 52.17 please visit the Native Vegetation Information Management system <https://nvim.delwp.vic.gov.au/> and [Native vegetation \(environment.vic.gov.au\)](#) or please contact your relevant council.

You can find out more about the natural values on your property through NatureKit [NatureKit \(environment.vic.gov.au\)](#)



AGRICULTURAL LICENCE

LAND ACT 1958 **Section 130**

THIS LICENCE is granted by the Licenser to the Licensee and commences on the date set out in the Schedule.

In consideration of the payment of the licence fee and the conditions contained in this Licence, the Licenser or a person authorised by the Licenser, at the request of the Licensee **HEREBY AUTHORISES** the Licensee to use the Crown land described in the Schedule for the specified purposes set out in the Schedule.

This Licence is subject to the provisions of the *Land Act 1958* and Regulations thereunder, the licence conditions attached and any Statutory and other Special Conditions set out in the Schedule.

V. Jones

Signature of Licenser or Authorised person

Vannessa Jones
Manager
Transaction Centre

26 September 2016

The Licensee hereby agrees that payment of the Licence Fee, shown in Item 7 of the Schedule, by the Licensee shall constitute acceptance by the Licensee of this Licence and shall constitute an undertaking by the Licensee that the Licensee shall comply with the terms and conditions of this Licence.

NOTE:

- | | |
|----------|---|
| 1 | <i>This licence is not valid until payment of the Licence Fee shown in Item 7 of the Schedule is received by the Department of Environment, Land, Water & Planning.</i> |
| 2 | <i>This Licence is an important document and should be stored in a secure and safe place. It will be needed if you sell your property. In the event of loss, a replacement fee may be charged.</i> |

INDEX

SCHEDULE

PLAN

LICENCE CONDITIONS

1 Grant

2 Licensee's Obligations (Positive)

- 2.1 Licence fee**
- 2.2 Rates and Taxes**
- 2.3 Indemnity**
- 2.4 Maintenance,**
- 2.5 Fire Protection Works**
- 2.6 Condition at Termination**
- 2.7 Notice of Defects and other matters**
- 2.8 Compliance with Law**
- 2.9 Compliance with Directions**
- 2.10 Arrears and Interest**
- 2.11 Further Conditions**

3 Licensee's Obligations (Negative)

- 3.1 Use of Licensed land**
- 3.2 Allow rubbish**
- 3.3 Hazardous Chemicals**
- 3.4 Burning**
- 3.5 Assignment**
- 3.6 Licensor's Entry**
- 3.7 Void insurance**
- 3.8 Cultivation and Use of Licensed land**
- 3.9 Erection of Improvements**

4 General Conditions

- 4.1 Termination upon Default**
- 4.2 Termination without Default**
- 4.3 Licensee's Improvements**
- 4.4 Secretary may remove and dispose of property**
- 4.5 Licensor's/Secretary's Agents**
- 4.6 Notices**
- 4.7 Review of Licence fee**
- 4.8 Debt recovery**

5 Definitions

6 Interpretations

LICENCE SCHEDULE

- Licence No.** 2022946
- Licensors** MINISTER FOR ENVIRONMENT, CLIMATE CHANGE & WATER
- 3. Licensee** BRADLEY RUPERT BIBBY
- 4. Address** "BELLVUE PARK"
1006 BARKLY ROAD
NAVARRE, 3384
- 5. Commencement Date** 01 OCTOBER 1994
- 6. Term** 99 YEARS
- 7. Licence Fee** \$201.10 (Ex. GST)
- 8. Paid** IN FULL
- 9. Licensed Land** All that land being:
MUNICIPALITY OF PYRENEES
UNUSED ROAD SOUTH OF CROWN ALLOTMENT 46, SECTION D
PARISH OF BARKLY

AS INDICATED ON ATTACHED PLAN/S.
- 10. Area (Ha)** 2.6606
- 11. Powers under which land is granted** SECTION 130 LAND ACT 1958
- 12. Specified Purpose** GRAZING
- 13. Statutory and other Conditions**
THE LICENSEE MUST IF DIRECTED TO DO SO IN WRITING BY THE LICENSOR MAINTAIN
SUITABLE UNLOCKED SWING GATES, CATTLE PITS, RAMPS OR OTHER SUITABLE MEANS OF
PASSAGE IN ANY FENCE ACROSS THE LICENSED LAND.
- 14. Special Conditions**
NIL



Legend

Map Scale 1:18,314

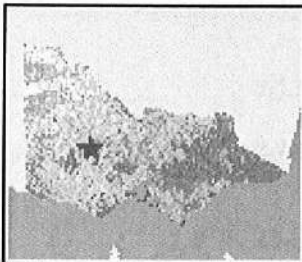

Overview Map

CLIP PLAN NOTICES	ROADS	WATERCOURSES
PARISH BOUNDARY	Freeway	Government Road
TOWNSHIP BOUNDARY	Highway	Road Main Government Road
PARCEL	Main Road	Government Road
CROWN PARCEL	Main Road (Disputed)	WATERCOURSE
Crown Parcel	Collector (Unmarked)	WATERCOURSE AREA
Watercourse	Local	Permanent Waterbody

Disclaimer: This map is a snapshot generated from Victorian Government data. This material may be of assistance to you but the State of Victoria does not guarantee that the publication is without flaw of any kind or is wholly appropriate for your particular purposes and therefore disclaims all liability for error, loss or damage which may arise from reliance upon it. All persons accessing this information should make appropriate enquiries to assess the currency of the data.

GDA
Victoria

State Government
Victoria

LICENCE CONDITIONS

1 **Grant**

The rights conferred by this Licence are non-exclusive, do not create or confer upon the Licensee any tenancy or any estate or interest in or over the licensed land or any part of it, and do not comprise or include any rights other than those granted or to which the Licensee is otherwise entitled by law.

2 **Licensee's Obligations (Positive)**

The Licensee Hereby Covenants with the Licensor that during the term the Licensee will: -

2.1 **Licence fee**

Duly and punctually pay or cause to be paid the licence fee to the Licensor at the payment address advised by the Licensor from time to time on the days and in the manner provided in Item 8 of the Schedule without demand, deduction, set-off or abatement.

2.2 **Rates and Taxes**

2.2.1 Duly and punctually pay as and when they respectively fall due all rates and taxes on the licensed land.

2.2.2 If requested to do so by the Licensor, produce receipts to the Licensor evidencing payment of the rates and taxes.

2.2.3 Duly and punctually pay to the Licensor at the same time and in the same manner as the licence fee is payable to the Licensor (or as otherwise notified to the Licensee by the Licensor) under clause 2.1 above the amount of any GST payable on or in relation to this licence and/or the rent payable thereunder or that becomes payable by the Licensor during the period covered by the fee.

2.3 **Indemnity**

Indemnify the Crown in respect of any claim or liability for property damage and/or injury or death of any person which arises directly or indirectly out of negligence, tort, contract, or breach of a statutory duty by the Licensee or any associated party consequential to the use or occupation of the licensed land, including, but without restricting the generality of the foregoing, the pollution or contamination of land or water, and any costs, charges and expenses incurred in connection therewith.

2.4 **Maintenance**

2.4.1 Throughout the term keep the licensed land in good order and condition and the improvements (if any) on it in good order and condition having regard to their condition at the commencement date or, if constructed or added to the licensed land after the commencement date, at the date of such construction or addition as the case may be and in particular but without restricting the generality of the foregoing will: -

2.4.1.1 Keep the licensed land free of pest animals and weeds;

2.4.1.2 Remedy every default of which notice is given by the Licensor to the Licensee within a reasonable time specified in the notice but in any event the time specified in the notice will not be less than 14 days.

2.5 **Fire Protection Works**

Undertake all fire protection works on the licensed land required by law to the satisfaction of the Licensor and the responsible fire Authority

2.6 **Condition at Termination**

On expiry or prior determination of this Licence return the licensed land to the Licensor in good order and condition and otherwise in accordance with the Licensee's obligations.

2.7 **Notice of Defects and other matters**

2.7.1 Give the Licensor prompt notice in writing of any accident to or defect in the licensed land and of any circumstances likely to cause any damage risk or hazard to the licensed land or any person on it;

2.7.2 Give to the Licensor within 7 days of its receipt by the Licensee a true copy of every notice, proposal or order given, issued or made in respect of the licensed land and full details of the circumstances of it;

2.7.3 Without delay take all necessary steps to comply with any notice, proposal or order referred to in paragraph 2.7.2 with which the Licensee is required to comply; and

2.7.4 At the request of the Licensor make or join with the Licensor in making such objections or representations against or in respect of any notice, proposal or order referred to in paragraph 2.7.2 as the Licensor deems expedient.

2.8 **Compliance with Law**

Comply at the Licensee's cost with the provisions of all statutes, regulations, local laws and by-laws relating to the licensed land and all lawful orders or direction made under them;

2.9 Compliance with Directions

2.9.1 At the Licensee's cost forthwith comply with any written direction given by the Secretary during the term as to the: -

- 2.9.1.1** grazing or management of the licensed land (including fencing), or the number and type of stock which may be depastured on the licensed land;
- 2.9.1.2** frequency, timing and method of cultivation;
- 2.9.1.3** water supply and other improvements;
- 2.9.1.4** reclamation of eroded areas and land degradation; or
- 2.9.1.5** retention or clearance of native vegetation.

2.10 Arrears and Interest

2.10.1 Pay to the Licensor: -

- 2.10.1.1** on any moneys payable by the Licensee to the Licensor and outstanding for thirty (30) days or on any judgment for the Licensor in an action arising under the Licence, interest at the penalty rate of interest for the time being made payable under the *Penalty Interest Rates Act 1983* computed from the date the moneys or judgment became payable until all moneys (including interest on them) are paid in full;
- 2.10.1.2** on demand all the Licensor's legal costs and disbursements payable in respect of or in connection with any assignment of this Licence or under-licensing of the licensed land, any surrender of this Licence, the giving of any consent by the Licensor or any failure by the Licensee to perform and observe this Licence, or any deed or other document executed in connection with this Licence.

2.11 Further Conditions

Comply with the Statutory and other Conditions contained in Item 13 of the Schedule and with the Special Conditions contained in Item 14 of the Schedule.

3 Licensee's Obligations (Negative)

The Licensee Hereby Covenants with the Licensor that during the term the Licensee will not -

3.1 Use of Licensed land

Use the licensed land for any purpose other than the specified purpose referred to in Item 12 of the Schedule or any additional purpose specified in Item 14 of the Schedule without first obtaining the Licensor's written consent which can be given or withheld at the absolute discretion of the Licensor or be given subject to conditions.

3.2 Allow rubbish

Permit any rubbish to accumulate in or about the licensed land.

3.3 Hazardous Chemicals

Keep any hazardous chemical on the licensed land without the Licensor's written consent which can be given or withheld at the absolute discretion of the Licensor or be given subject to conditions.

3.4 Burning

Undertake any burning of vegetation or any other matter on the licensed land without first obtaining any necessary permit and the written approval of the Licensor which can be given or withheld at the absolute discretion of the Licensor or be given subject to conditions PROVIDED HOWEVER that the consent of the Licensor is not required for the burning of crop stubble.

3.5 Assignment

Without first obtaining the written consent of the Licensor assign, under-license, mortgage, or charge this Licence or part with or share possession of the licensed land or any part of it.

3.6 Licensor's Entry

3.6.1 Prevent, attempt to prevent or in any other way hinder, obstruct or permit the hindrance or obstruction of the Licensor or the Licensor's employee or agent at any time from entering and remaining on the licensed land either with or without motor vehicles or other equipment for any purpose and in particular, but without restricting the generality of the foregoing, for any of the following purposes:-

- 3.6.1.1** retaking or attempting to retake possession of the licensed land;
- 3.6.1.2** inspection; or
- 3.6.1.3** any other lawful purpose.

3.7 Void insurance

Do or allow anything to be done which might result in any insurance's relating to the licensed land becoming void or voidable or which might increase the premium on any insurance.

3.8 Cultivation and Use of Licensed land

3.8.1 Without the Licensor's prior written approval, which can be given or withheld at the absolute discretion of the Licensor or be given subject to conditions, :-

- 3.8.1.1 fell, ringbark, injure, destroy or remove any living or dead vegetation (except weeds) or fallen timber on the licensed land;
- 3.8.1.2 plough, cultivate, work, break up or remove soil or construct any earthworks on the licensed land;
- 3.8.1.3 plant any vegetation, seed or crop on the licensed land; or
- 3.8.1.4 apply fertilizer to the licensed land.

3.9 Erection of Improvements

Erect or permit the erection of any improvement on the licensed land without the Licensor's prior written approval, which can be given or withheld at the absolute discretion of the Licensor or be given subject to conditions.

4 General Conditions

4.1 Termination upon Default

If the Licensor is satisfied, after giving the Licensee a reasonable opportunity to be heard, that the licensee has failed to comply with any terms or conditions of the licence, the Licensor may, by notice published in the Government Gazette, declare that the licence is cancelled, and upon cancellation the licensee will not be entitled to any compensation whatsoever.

4.2 Termination without Default

4.2.1 In addition to and not in substitution for the power to cancel this Licence under clause 4.1, the Licensor may by giving to the Licensee three months' written notice to that effect cancel this Licence upon a date to be specified in that notice notwithstanding that there has been no breach by the Licensee of any term or condition of this Licence.

4.2.2 If the licence is terminated under this clause the Licensee is entitled to receive and will be paid by the Licensor a refund of an amount of the licence fee paid.

4.2.3 The amount of refund will be determined by the Licensor on a pro rata basis, taking into account any period of the licence remaining at the date of cancellation.

4.2.4 Except as provided in sub clause 4.2.2 above no compensation is payable in respect of the cancellation of the licence.

4.3 Licensee's Improvements

4.3.1 The Licensee's improvements shall remain the property of the Licensee.

4.3.2 On the cancellation or expiration of the Licence the Licensee must, within a period of time specified by the Secretary, remove all Licensee's improvements from the licensed land and forthwith make good all damage caused to the licensed land by the affixing, retention or removal of Licensee's improvements to the satisfaction of the Secretary.

4.4 Secretary may remove and dispose of property

If the Licence expires, or is cancelled under clauses 4.1 or 4.2, the Secretary may at the end of the period of time specified under Clause 4.3.2 remove the Licensee's chattels and improvements and store them at the Licensee's expense without being liable to the Licensee for trespass, detinue, conversion or negligence. After storing them for at least one month, the Secretary may sell or dispose of them by auction, private sale, gift, distribution or otherwise and apply the net proceeds towards the payment of any moneys owed by the Licensee to the Licensor.

4.5 Licensor's/Secretary's Agents

Every act or thing to be done, decision to be made or document to be signed pursuant to this Licence by the Licensor or the Secretary and not required by law to be done, made or signed by the Licensor or the Secretary personally may be done made or signed by any person to whom such power has been delegated by the Licensor or the Secretary.

4.6 Notices

Any notice consent or demand or other communication to be served on or given to the Licensee by the Licensor under this Licence shall be deemed to have been duly served or given if it is in writing signed by the Licensor and delivered or sent by pre paid post to the Licensee's address set out in Item 4 of the Schedule or to the latest address stated by the Licensee in any written communication with the Licensor.

4.7 Review of Licence fee

The licence fee, unless it has been paid in full for the term, will be reviewed by the Licensor every three years from 1st October 1997, and the reviewed fee shall commence on the day following the date fixed for each such review.

4.8 Debt recovery

All moneys payable by the Licensee to the Licensor under this Licence are recoverable from the Licensee as liquidated debts payable on demand.

Definitions

Unless inconsistent with the context or subject matter each word or phrase defined in this clause has the same meaning when used elsewhere in the licence.

"**commencement date**" means the date described in Item 5 of the Schedule and is the first day of the term;

"**Crown**" means the Crown in right of the State of Victoria and includes the Secretary and each employee and agent of the Crown or the Secretary;

"**GST**" means a goods and services tax within the meaning of the *A New Tax System (Goods and Services Tax) Act 1999*.

"**Department**" means the Department of Environment, Land, Water & Planning or its successor in law;

"**flora**" has the same meaning as in the *Flora and Fauna Guarantee Act 1988*;

"**hazardous chemical**" includes gas, inflammable liquid, explosive substance, pesticide, herbicide, fertiliser and other chemicals;

"**improvement**" includes building, dam, levee, channel, sign, permanent fence, or other structure and any addition to an existing improvement;

"**licensed land**" means the land described in Item 9 of the Schedule;

"**Licence fee**" means the licence fee described in Item 7 of the Schedule as varied during the term;

"**Licensee**" means the person named in Item 3 of the Schedule and includes the permitted assigns and successors in law to a Licensee;

"**Licensee's Improvements**" includes growing crop, building, structure, sign, fence and any other structural improvement including dam, levee, channel or any other earthworks but does not include any such improvement shown in Item 14 of the Schedule as being or becoming the property of the Licensor.

"**Licensor**" means the Minister of the Crown for the time being administering Division 8 of Part 1 of the *Land Act 1958* or such other Minister of the Crown or Government Authority to whom responsibility for this Licence may at any time be given;

"**person**" includes a body corporate as well as an individual;

"**pest animals**" has the same meaning as in the *Catchment and Land Protection Act 1994*;

"**rates and taxes**" means all existing and future rates (including excess water rates and any special rates or levies) taxes, charges, tariffs, assessments, impositions and outgoings whatsoever now or at any time imposed, charged or assessed on or against the licensed land or the Licensor or the Licensee or payable by the owner or occupier of the licensed land;

"**schedule**" means the schedule to this Licence;

"**Secretary**" means The Secretary to the Department of Environment, Land, Water & Planning, the body corporate established under the *Conservation, Forests and Lands Act 1987*;

"**sign**" includes names, advertisements and notices;

"**soil**" includes gravel, stone, salt, guano, shell, sand, loam and brick earth;

"**term**" means the period of time set out in Item 6 of the Schedule, as and from the commencement date;

"**weeds**" include noxious weeds within the meaning of the *Catchment and Land Protection Act 1994*, and prescribed flora within the meaning of the *Flora and Fauna Guarantee Act 1988*;

"**writing**" includes typewriting, printing, photography, lithography and other modes of representing or reproducing words in a visible form and "written" has a corresponding meaning.

Interpretations

6.1 A reference importing the singular includes the plural and vice versa.

6.2 The index and headings are included for ease of reference and do not alter the interpretation of this Licence.

6.3 If any day appointed or specified by this Licence falls on a Saturday, Sunday or a day appointed under the *Public Holidays Act 1993* as a holiday for the whole day the day so appointed or specified is deemed to be the first day succeeding the day appointed or specified which is not a Saturday, Sunday or day appointed as a holiday.

6.4 References to an Act of Parliament or a section or schedule of it shall be read as if the words "or any statutory modification or re-enactment thereof or substitution therefor" were added to the reference.

6.5 If the Licensee comprises more than one person, the covenants and agreements contained in this Licence shall be construed as having been entered into by, and are binding, both jointly and severally on all and each of the persons who constitute the Licensee.

6.6 References to clauses, sub-clauses and Items are references to clauses, sub-clauses and Items of this Licence respectively.



AGRICULTURAL LICENCE

LAND ACT 1958 **Section 130**

THIS LICENCE is granted by the Licensor to the Licensee and commences on the date set out in the Schedule.

In consideration of the payment of the licence fee and the conditions contained in this Licence, the Licensor or a person authorised by the Licensor, at the request of the Licensee **HEREBY AUTHORISES** the Licensee to use the Crown land described in the Schedule for the specified purposes set out in the Schedule.

This Licence is subject to the provisions of the *Land Act 1958* and Regulations thereunder, the licence conditions attached and any Statutory and other Special Conditions set out in the Schedule.

.....
Signature of Licensor or Authorised person

Vannessa Jones
Manager
Transaction Centre

26 September 2016

The Licensee hereby agrees that payment of the Licence Fee, shown in Item 7 of the Schedule, by the Licensee shall constitute acceptance by the Licensee of this Licence and shall constitute an undertaking by the Licensee that the Licensee shall comply with the terms and conditions of this Licence.

NOTE:

- | | |
|----------|---|
| 1 | <i>This licence is not valid until payment of the Licence Fee shown in Item 7 of the Schedule is received by the Department of Environment, Land, Water & Planning.</i> |
| 2 | <i>This Licence is an important document and should be stored in a secure and safe place. It will be needed if you sell your property. In the event of loss, a replacement fee may be charged.</i> |

INDEX

SCHEDULE

PLAN

LICENCE CONDITIONS

- 1 Grant**
- 2 Licensee's Obligations (Positive)**
 - 2.1 Licence fee**
 - 2.2 Rates and Taxes**
 - 2.3 Indemnity**
 - 2.4 Maintenance,**
 - 2.5 Fire Protection Works**
 - 2.6 Condition at Termination**
 - 2.7 Notice of Defects and other matters**
 - 2.8 Compliance with Law**
 - 2.9 Compliance with Directions**
 - 2.10 Arrears and Interest**
 - 2.11 Further Conditions**
- 3 Licensee's Obligations (Negative)**
 - 3.1 Use of Licensed land**
 - 3.2 Allow rubbish**
 - 3.3 Hazardous Chemicals**
 - 3.4 Burning**
 - 3.5 Assignment**
 - 3.6 Licensor's Entry**
 - 3.7 Void insurance**
 - 3.8 Cultivation and Use of Licensed land**
 - 3.9 Erection of Improvements**
- 4 General Conditions**
 - 4.1 Termination upon Default**
 - 4.2 Termination without Default**
 - 4.3 Licensee's Improvements**
 - 4.4 Secretary may remove and dispose of property**
 - 4.5 Licensor's/Secretary's Agents**
 - 4.6 Notices**
 - 4.7 Review of Licence fee**
 - 4.8 Debt recovery**
- 5 Definitions**
- 6 Interpretations**

LICENCE SCHEDULE

Licence No. 2022948
2. Licensor MINISTER FOR ENVIRONMENT, CLIMATE CHANGE & WATER
3. Licensee BRADLEY RUPERT BIBBY
4. Address "BELLVUE PARK"
1006 BARKLY ROAD
NAVARRE, 3384

5. Commencement Date 01 OCTOBER 2014

6. Term 5 YEARS

7. Licence Fee \$80.00 (Ex. GST)

8. Paid IN FULL

9. Licensed Land All that land being:

MUNICIPALITY OF PYRENEES
WATER FRONTAGE BEING CROWN ALLOTMENT 46A SECTION D
TRAVERSING CROWN ALLOTMENT 46 SECTION D
PARISH OF BARKLY

AS INDICATED ON ATTACHED PLAN/S.

10. Area (Ha) 5.7461

11. Powers under which land is granted SECTION 130 LAND ACT 1958

12. Specified Purpose GRAZING

13. Statutory and other Conditions

THE LICENSEE

(A) MUST ERECT AND MAINTAIN A STILE, GATE OR SOME OTHER SUITABLE MEANS OF PEDESTRIAN ACCESS IN ANY FENCE OR FENCES ON OR AROUND THE LICENSED LAND EXCEPT ANY FENCE BETWEEN THE LICENSED LAND AND ADJOINING PRIVATE LAND; AND

(B) MUST NOT ERECT OR PERMIT TO REMAIN ERECTED ON THE LICENSED LAND OR ON ANY FENCE ACROSS THE LICENSED LAND ANY SIGNS THAT PURPORT OR CONVEY THAT PUBLIC PEDESTRIAN ACCESS TO THE LICENSED LAND IS RESTRICTED IN ANY WAY; AND

(C) PURSUANT TO SECTION 401A OF THE LAND ACT 1958 ACKNOWLEDGES THAT ANY PERSON MAY ENTER AND REMAIN ON THE LICENSED LAND FOR RECREATIONAL PURPOSES (EXCEPT CAMPING) AND THE LICENSEE MUST NOT DO ANYTHING TO SUGGEST OR CONVEY TO ANY PERSON THAT HE OR SHE MAY NOT ENTER THE LICENSED LAND FOR THIS PURPOSE.

14. Special Conditions

NIL

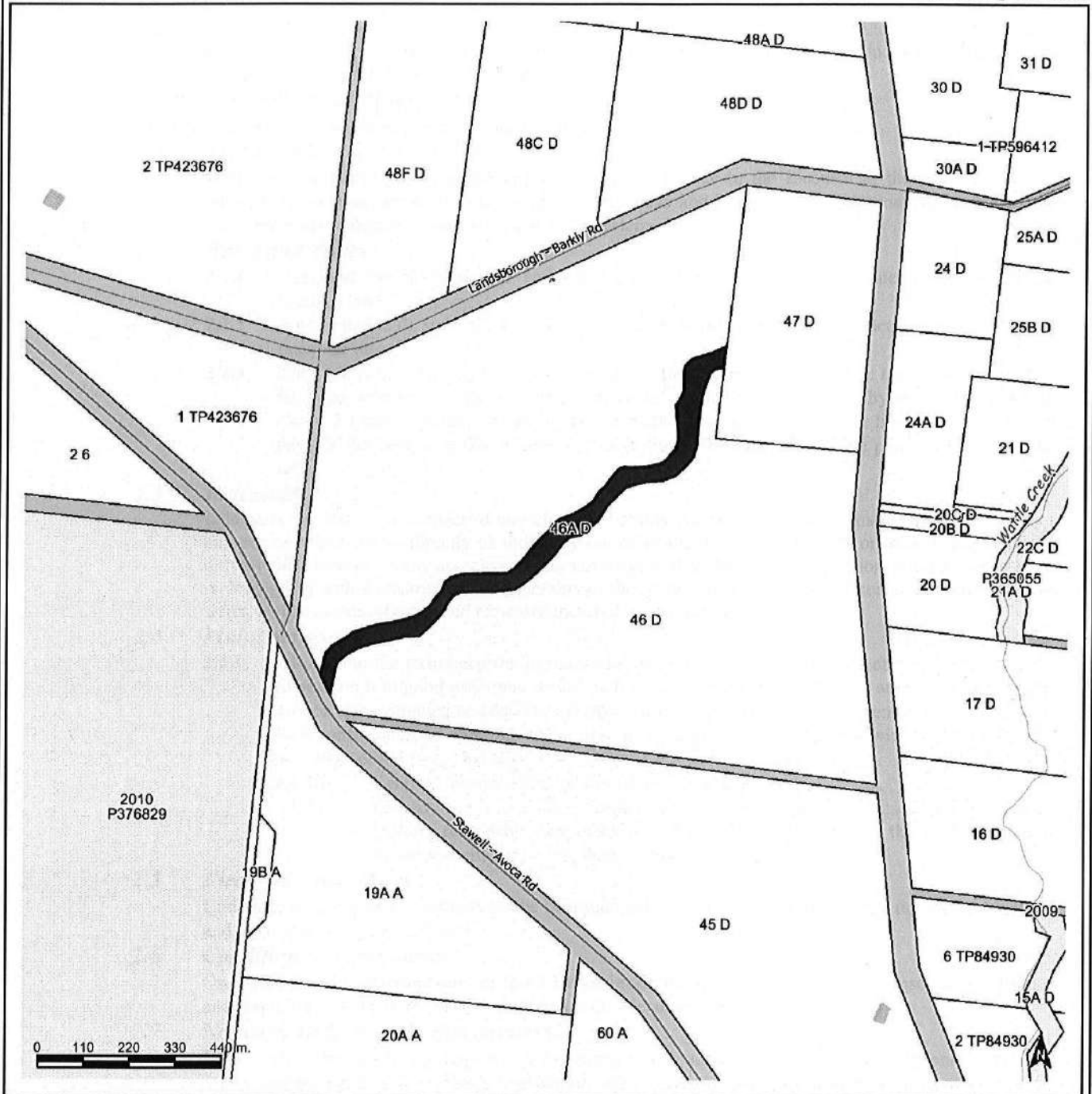

0 110 220 330 440 m.

Legend

Map Scale 1:12,989

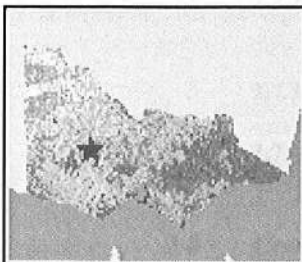

Overview Map

PARISH BOUNDARY	ROAD	WATERCOURSE
TOWNSHIP BOUNDARY	Freeway	Overland Road
PARCEL	Highway	Road State Government Road
CROWN PARCELS	Main Road	Government Road
Green land	Main Road (Unimproved)	WATERCOURSE
Irrigated land	Collector	Watercourse Road
Government Road	Collector (Broadford)	Permanent Water body
	Local	

Disclaimer: This map is a snapshot generated from Victorian Government data. This material may be of assistance to you but the State of Victoria does not guarantee that the publication is without flaw of any kind or is wholly appropriate for your particular purposes and therefore disclaims all liability for error, loss or damage which may arise from reliance upon it. All persons accessing this information should make appropriate enquiries to assess the currency of the data.

LICENCE CONDITIONS

1 Grant

The rights conferred by this Licence are non-exclusive, do not create or confer upon the Licensee any tenancy or any estate or interest in or over the licensed land or any part of it, and do not comprise or include any rights other than those granted or to which the Licensee is otherwise entitled by law.

2 Licensee's Obligations (Positive)

The Licensee Hereby Covenants with the Licensors that during the term the Licensee will: -

2.1 Licence fee

Duly and punctually pay or cause to be paid the licence fee to the Licensors at the payment address advised by the Licensors from time to time on the days and in the manner provided in Item 8 of the Schedule without demand, deduction, set-off or abatement.

2.2 Rates and Taxes

2.2.1 Duly and punctually pay as and, when they respectively fall due all rates and taxes on the licensed land.

2.2.2 If requested to do so by the Licensors, produce receipts to the Licensors evidencing payment of the rates and taxes.

2.2.3 Duly and punctually pay to the Licensors at the same time and in the same manner as the licence fee is payable to the Licensors (or as otherwise notified to the Licensee by the Licensors) under clause 2.1 above the amount of any GST payable on or in relation to this licence and/or the rent payable thereunder or that becomes payable by the Licensors during the period covered by the fee.

2.3 Indemnity

Indemnify the Crown in respect of any claim or liability for property damage and/or injury or death of any person which arises directly or indirectly out of negligence, tort, contract, or breach of a statutory duty by the Licensee or any associated party consequential to the use or occupation of the licensed land, including, but without restricting the generality of the foregoing, the pollution or contamination of land or water, and any costs, charges and expenses incurred in connection therewith.

2.4 Maintenance

2.4.1 Throughout the term keep the licensed land in good order and condition and the improvements (if any) on it in good order and condition having regard to their condition at the commencement date or, if constructed or added to the licensed land after the commencement date, at the date of such construction or addition as the case may be and in particular but without restricting the generality of the foregoing will: -

2.4.1.1 Keep the licensed land free of pest animals and weeds;

2.4.1.2 Remedy every default of which notice is given by the Licensors to the Licensee within a reasonable time specified in the notice but in any event the time specified in the notice will not be less than 14 days.

2.5 Fire Protection Works

Undertake all fire protection works on the licensed land required by law to the satisfaction of the Licensors and the responsible fire Authority

2.6 Condition at Termination

On expiry or prior determination of this Licence return the licensed land to the Licensors in good order and condition and otherwise in accordance with the Licensee's obligations.

2.7 Notice of Defects and other matters

2.7.1 Give the Licensors prompt notice in writing of any accident to or defect in the licensed land and of any circumstances likely to cause any damage risk or hazard to the licensed land or any person on it;

2.7.2 Give to the Licensors within 7 days of its receipt by the Licensee a true copy of every notice, proposal or order given, issued or made in respect of the licensed land and full details of the circumstances of it;

2.7.3 Without delay take all necessary steps to comply with any notice, proposal or order referred to in paragraph 2.7.2 with which the Licensee is required to comply; and

2.7.4 At the request of the Licensors make or join with the Licensors in making such objections or representations against or in respect of any notice, proposal or order referred to in paragraph 2.7.2 as the Licensors deems expedient.

2.8 Compliance with Law

Comply at the Licensee's cost with the provisions of all statutes, regulations, local laws and by-laws relating to the licensed land and all lawful orders or direction made under them;

2.9 Compliance with Directions

2.9.1 At the Licensee's cost forthwith comply with any written direction given by the Secretary during the term as to the:-

- 2.9.1.1** grazing or management of the licensed land (including fencing), or the number and type of stock which may be depastured on the licensed land;
- 2.9.1.2** frequency, timing and method of cultivation;
- 2.9.1.3** water supply and other improvements;
- 2.9.1.4** reclamation of eroded areas and land degradation; or
- 2.9.1.5** retention or clearance of native vegetation.

2.10 Arrears and Interest

2.10.1 Pay to the Licensors:-

- 2.10.1.1** on any moneys payable by the Licensee to the Licensors and outstanding for thirty (30) days or on any judgment for the Licensors in an action arising under the Licence, interest at the penalty rate of interest for the time being made payable under the *Penalty Interest Rates Act 1983* computed from the date the moneys or judgment became payable until all moneys (including interest on them) are paid in full;
- 2.10.1.2** on demand all the Licensors's legal costs and disbursements payable in respect of or in connection with any assignment of this Licence or under-licensing of the licensed land, any surrender of this Licence, the giving of any consent by the Licensors or any failure by the Licensee to perform and observe this Licence, or any deed or other document executed in connection with this Licence.

2.11 Further Conditions

Comply with the Statutory and other Conditions contained in Item 13 of the Schedule and with the Special Conditions contained in Item 14 of the Schedule.

3 Licensee's Obligations (Negative)

The Licensee Hereby Covenants with the Licensors that during the term the Licensee will not -

3.1 Use of Licensed land

Use the licensed land for any purpose other than the specified purpose referred to in Item 12 of the Schedule or any additional purpose specified in Item 14 of the Schedule without first obtaining the Licensors's written consent which can be given or withheld at the absolute discretion of the Licensors or be given subject to conditions.

3.2 Allow rubbish

Permit any rubbish to accumulate in or about the licensed land.

3.3 Hazardous Chemicals

Keep any hazardous chemical on the licensed land without the Licensors's written consent which can be given or withheld at the absolute discretion of the Licensors or be given subject to conditions.

3.4 Burning

Undertake any burning of vegetation or any other matter on the licensed land without first obtaining any necessary permit and the written approval of the Licensors which can be given or withheld at the absolute discretion of the Licensors or be given subject to conditions PROVIDED HOWEVER that the consent of the Licensors is not required for the burning of crop stubble.

3.5 Assignment

Without first obtaining the written consent of the Licensors assign, under-license, mortgage, or charge this Licence or part with or share possession of the licensed land or any part of it.

3.6 Licensors's Entry

3.6.1 Prevent, attempt to prevent or in any other way hinder, obstruct or permit the hindrance or obstruction of the Licensors or the Licensors's employee or agent at any time from entering and remaining on the licensed land either with or without motor vehicles or other equipment for any purpose and in particular, but without restricting the generality of the foregoing, for any of the following purposes:-

- 3.6.1.1** retaking or attempting to retake possession of the licensed land;
- 3.6.1.2** inspection; or
- 3.6.1.3** any other lawful purpose.

3.7 Void insurance

Do or allow anything to be done which might result in any insurance's relating to the licensed land becoming void or voidable or which might increase the premium on any insurance.

3.8 Cultivation and Use of Licensed land

- 3.8.1 Without the Licensor's prior written approval, which can be given or withheld at the absolute discretion of the Licensor or be given subject to conditions, :-
- 3.8.1.1 fell, ringbark, injure, destroy or remove any living or dead vegetation (except weeds) or fallen timber on the licensed land;
 - 3.8.1.2 plough, cultivate, work, break up or remove soil or construct any earthworks on the licensed land;
 - 3.8.1.3 plant any vegetation, seed or crop on the licensed land; or
 - 3.8.1.4 apply fertilizer to the licensed land.

3.9 Erection of Improvements

Erect or permit the erection of any improvement on the licensed land without the Licensor's prior written approval, which can be given or withheld at the absolute discretion of the Licensor or be given subject to conditions.

4 General Conditions

4.1 Termination upon Default

If the Licensor is satisfied, after giving the Licensee a reasonable opportunity to be heard, that the licensee has failed to comply with any terms or conditions of the licence, the Licensor may, by notice published in the Government Gazette, declare that the licence is cancelled, and upon cancellation the licensee will not be entitled to any compensation whatsoever.

4.2 Termination without Default

- 4.2.1 In addition to and not in substitution for the power to cancel this Licence under clause 4.1, the Licensor may by giving to the Licensee three months' written notice to that effect cancel this Licence upon a date to be specified in that notice notwithstanding that there has been no breach by the Licensee of any term or condition of this Licence.
- 4.2.2 If the licence is terminated under this clause the Licensee is entitled to receive and will be paid by the Licensor a refund of an amount of the licence fee paid.
- 4.2.3 The amount of refund will be determined by the Licensor on a pro rata basis, taking into account any period of the licence remaining at the date of cancellation.
- 4.2.4 Except as provided in sub clause 4.2.2 above no compensation is payable in respect of the cancellation of the licence.

4.3 Licensee's Improvements

- 4.3.1 The Licensee's improvements shall remain the property of the Licensee.
- 4.3.2 On the cancellation or expiration of the Licence the Licensee must, within a period of time specified by the Secretary, remove all Licensee's improvements from the licensed land and forthwith make good all damage caused to the licensed land by the affixing, retention or removal of Licensee's improvements to the satisfaction of the Secretary.

4.4 Secretary may remove and dispose of property

If the Licence expires, or is cancelled under clauses 4.1 or 4.2, the Secretary may at the end of the period of time specified under Clause 4.3.2 remove the Licensee's chattels and improvements and store them at the Licensee's expense without being liable to the Licensee for trespass, detainee, conversion or negligence. After storing them for at least one month, the Secretary may sell or dispose of them by auction, private sale, gift, distribution or otherwise and apply the net proceeds towards the payment of any moneys owed by the Licensee to the Licensor.

4.5 Licensor's/Secretary's Agents

Every act or thing to be done, decision to be made or document to be signed pursuant to this Licence by the Licensor or the Secretary and not required by law to be done, made or signed by the Licensor or the Secretary personally may be done made or signed by any person to whom such power has been delegated by the Licensor or the Secretary.

4.6 Notices

Any notice consent or demand or other communication to be served on or given to the Licensee by the Licensor under this Licence shall be deemed to have been duly served or given if it is in writing signed by the Licensor and delivered or sent by pre paid post to the Licensee's address set out in Item 4 of the Schedule or to the latest address stated by the Licensee in any written communication with the Licensor.

4.7 Review of Licence fee

The licence fee, unless it has been paid in full for the term, will be reviewed by the Licensor every three years from 1st October 1997, and the reviewed fee shall commence on the day following the date fixed for each such review.

4.8 Debt recovery

All moneys payable by the Licensee to the Licensor under this Licence are recoverable from the Licensee as liquidated debts payable on demand.

Definitions

Unless inconsistent with the context or subject matter each word or phrase defined in this clause has the same meaning when used elsewhere in the licence.

"**commencement date**" means the date described in Item 5 of the Schedule and is the first day of the term;

"**Crown**" means the Crown in right of the State of Victoria and includes the Secretary and each employee and agent of the Crown or the Secretary;

"**GST**" means a goods and services tax within the meaning of the *A New Tax System (Goods and Services Tax) Act 1999*.

"**Department**" means the Department of Environment, Land, Water & Planning or its successor in law;

"**flora**" has the same meaning as in the *Flora and Fauna Guarantee Act 1988*;

"**hazardous chemical**" includes gas, inflammable liquid, explosive substance, pesticide, herbicide, fertiliser and other chemicals;

"**improvement**" includes building, dam, levee, channel, sign, permanent fence, or other structure and any addition to an existing improvement;

"**licensed land**" means the land described in Item 9 of the Schedule;

"**Licence fee**" means the licence fee described in Item 7 of the Schedule as varied during the term;

"**Licensee**" means the person named in Item 3 of the Schedule and includes the permitted assigns and successors in law to a Licensee;

"**Licensee's Improvements**" includes growing crop, building, structure, sign, fence and any other structural improvement including dam, levee, channel or any other earthworks but does not include any such improvement shown in Item 14 of the Schedule as being or becoming the property of the Licensor.

"**Licensor**" means the Minister of the Crown for the time being administering Division 8 of Part 1 of the *Land Act 1958* or such other Minister of the Crown or Government Authority to whom responsibility for this Licence may at any time be given;

"**person**" includes a body corporate as well as an individual;

"**pest animals**" has the same meaning as in the *Catchment and Land Protection Act 1994*;

"**rates and taxes**" means all existing and future rates (including excess water rates and any special rates or levies) taxes, charges, tariffs, assessments, impositions and outgoings whatsoever now or at any time imposed, charged or assessed on or against the licensed land or the Licensor or the Licensee or payable by the owner or occupier of the licensed land;

"**schedule**" means the schedule to this Licence;

"**Secretary**" means The Secretary to the Department of Environment, Land, Water & Planning, the body corporate established under the *Conservation, Forests and Lands Act 1987*;

"**sign**" includes names, advertisements and notices;

"**soil**" includes gravel, stone, salt, guano, shell, sand, loam and brick earth;

"**term**" means the period of time set out in Item 6 of the Schedule, as and from the commencement date;

"**weeds**" include noxious weeds within the meaning of the *Catchment and Land Protection Act 1994*, and prescribed flora within the meaning of the *Flora and Fauna Guarantee Act 1988*;

"**writing**" includes typewriting, printing, photography, lithography and other modes of representing or reproducing words in a visible form and "written" has a corresponding meaning.

6

Interpretations

6.1 A reference importing the singular includes the plural and vice versa.

6.2 The index and headings are included for ease of reference and do not alter the interpretation of this Licence.

6.3 If any day appointed or specified by this Licence falls on a Saturday, Sunday or a day appointed under the *Public Holidays Act 1993* as a holiday for the whole day the day so appointed or specified is deemed to be the first day succeeding the day appointed or specified which is not a Saturday, Sunday or day appointed as a holiday.

6.4 References to an Act of Parliament or a section or schedule of it shall be read as if the words "or any statutory modification or re-enactment thereof or substitution therefor" were added to the reference.

6.5 If the Licensee comprises more than one person, the covenants and agreements contained in this Licence shall be construed as having been entered into by, and are binding, both jointly and severally on all and each of the persons who constitute the Licensee.

6.6 References to clauses, sub-clauses and Items are references to clauses, sub-clauses and Items of this Licence respectively.

Due diligence checklist

What you need to know before buying a residential property

Before you buy a home, you should be aware of a range of issues that may affect that property and impose restrictions or obligations on you, if you buy it. This checklist aims to help you identify whether any of these issues will affect you. The questions are a starting point only and you may need to seek professional advice to answer some of them. You can find links to organisations and web pages that can help you learn more, by visiting the [Due diligence checklist page on the Consumer Affairs Victoria website](http://consumer.vic.gov.au/duediligencechecklist) (consumer.vic.gov.au/duediligencechecklist).

Urban living

Moving to the inner city?

High density areas are attractive for their entertainment and service areas, but these activities create increased traffic as well as noise and odours from businesses and people. Familiarising yourself with the character of the area will give you a balanced understanding of what to expect.

Is the property subject to an owners corporation?

If the property is part of a subdivision with common property such as driveways or grounds, it may be subject to an owners corporation. You may be required to pay fees and follow rules that restrict what you can do on your property, such as a ban on pet ownership.

Growth areas

Are you moving to a growth area?

You should investigate whether you will be required to pay a growth areas infrastructure contribution.

Flood and fire risk

Does this property experience flooding or bushfire?

Properties are sometimes subject to the risk of fire and flooding due to their location. You should properly investigate these risks and consider their implications for land management, buildings and insurance premiums.

Rural properties

Moving to the country?

If you are looking at property in a rural zone, consider:

- Is the surrounding land use compatible with your lifestyle expectations? Farming can create noise or odour that may be at odds with your expectations of a rural lifestyle.
- Are you considering removing native vegetation? There are regulations which affect your ability to remove native vegetation on private property.
- Do you understand your obligations to manage weeds and pest animals?

Can you build new dwellings?

Does the property adjoin crown land, have a water frontage, contain a disused government road, or are there any crown licences associated with the land?

Is there any earth resource activity such as mining in the area?

You may wish to find out more about exploration, mining and quarrying activity on or near the property and consider the issue of petroleum, geothermal and greenhouse gas sequestration permits, leases and licences, extractive industry authorisations and mineral licences.

Soil and groundwater contamination

Has previous land use affected the soil or groundwater?

You should consider whether past activities, including the use of adjacent land, may have caused contamination at the site and whether this may prevent you from doing certain things to or on the land in the future.

(04/10/2016)

Land boundaries

Do you know the exact boundary of the property?

You should compare the measurements shown on the title document with actual fences and buildings on the property, to make sure the boundaries match. If you have concerns about this, you can speak to your lawyer or conveyancer, or commission a site survey to establish property boundaries.

Planning controls

Can you change how the property is used, or the buildings on it?

All land is subject to a planning scheme, run by the local council. How the property is zoned and any overlays that may apply, will determine how the land can be used. This may restrict such things as whether you can build on vacant land or how you can alter or develop the land and its buildings over time.

The local council can give you advice about the planning scheme, as well as details of any other restrictions that may apply, such as design guidelines or bushfire safety design. There may also be restrictions – known as encumbrances – on the property's title, which prevent you from developing the property. You can find out about encumbrances by looking at the section 32 statement.

Are there any proposed or granted planning permits?

The local council can advise you if there are any proposed or issued planning permits for any properties close by. Significant developments in your area may change the local 'character' (predominant style of the area) and may increase noise or traffic near the property.

Safety

Is the building safe to live in?

Building laws are in place to ensure building safety. Professional building inspections can help you assess the property for electrical safety, possible illegal building work, adequate pool or spa fencing and the presence of asbestos, termites, or other potential hazards.

Building permits

Have any buildings or retaining walls on the property been altered, or do you plan to alter them?

There are laws and regulations about how buildings and retaining walls are constructed, which you may wish to investigate to ensure any completed or proposed building work is approved. The local council may be able to give you information about any building permits issued for recent building works done to the property, and what you must do to plan new work. You can also commission a private building surveyor's assessment.

Are any recent building or renovation works covered by insurance?

Ask the vendor if there is any owner-builder insurance or builder's warranty to cover defects in the work done to the property.

Utilities and essential services

Does the property have working connections for water, sewerage, electricity, gas, telephone and internet?

Unconnected services may not be available, or may incur a fee to connect. You may also need to choose from a range of suppliers for these services. This may be particularly important in rural areas where some services are not available.

Buyers' rights

Do you know your rights when buying a property?

The contract of sale and section 32 statement contain important information about the property, so you should request to see these and read them thoroughly. Many people engage a lawyer or conveyancer to help them understand the contracts and ensure the sale goes through correctly. If you intend to hire a professional, you should consider speaking to them before you commit to the sale. There are also important rules about the way private sales and auctions are conducted. These may include a cooling-off period and specific rights associated with 'off the plan' sales. The important thing to remember is that, as the buyer, you have rights.

(04/10/2016)